

QA11

1.0mm to 1.0mm

Features:
* Low VSWR

Applications:
* Wireless
* Transmitter
* Laboratory Test
* Radar

Electrical

Frequency:	DC~110GHz
VSWR:	1.35 max.
Insertion Loss:	0.6dB max.
Impedance:	50Ω

Mechanical

RF Connectors:	1.0mm
Mating Life Cycle:	2000 cycles
Outer Conductor:	Passivated SUS303 stainless steel or gold plated beryllium copper
Dielectric:	PEEK or CPS or PEI
Inner Conductor:	Gold plated beryllium copper

Environmental

Temperature: -55~+85°C

How To Order

- QA11-MM** - 1.0mm(m) to 1.0mm(m), Outline A
- QA11-MF** - 1.0mm(m) to 1.0mm(f), Outline B
- QA11-FF** - 1.0mm(f) to 1.0mm(f), Outline C
- QA11H-FF** - 1.0mm(f) to 1.0mm(f), bulk head, Outline D
- QA11L-FF** - 1.0mm(f) to 1.0mm(f), flange mount, Outline E

Customization is available upon request.

Outline Drawings

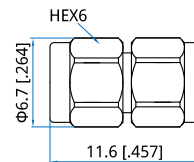

Outline A

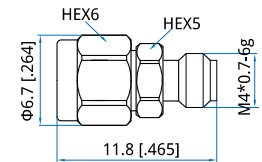

Outline B

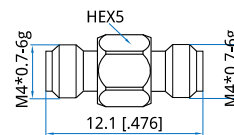

Outline C

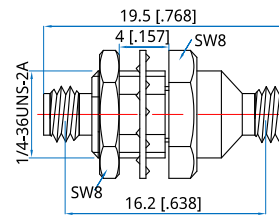

Outline D

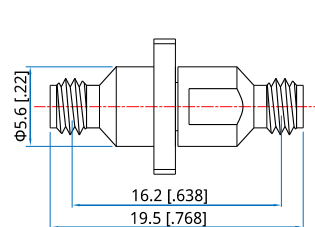
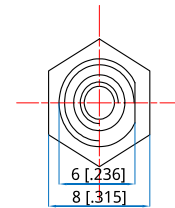

Outline E

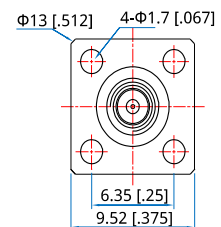

Unit: mm [in]
Tolerance: ±0.2mm [±0.008in]



ООО «4TECT»
Телефон: +7 (499) 685-4444
info@4test.ru
www.4test.ru

QAVV 1.85mm to 1.85mm

Features:
* Low VSWR

Applications:
* Wireless
* Transmitter
* Laboratory Test
* Radar

Electrical

Frequency: DC-67GHz
VSWR: 1.25 max.
Impedance: 50Ω

Mechanical

RF Connectors: 1.85mm
Mating Life Cycle: 500 cycles
Outer Conductor: Passivated Stainless Steel
Dielectric: PEI or PTFE
Inner Conductor: Gold Plated Beryllium Copper or gold plated brass

How To Order

QAVV-MM - 1.85mm(m) to 1.85mm(m), Outline A
QAVV-MF - 1.85mm(m) to 1.85mm(f), Outline B
QAVV-FF - 1.85mm(f) to 1.85mm(f), Outline C
QAVWR-MM - 1.85mm(m) to 1.85mm(m), right angle, Outline D
QAVWR-MF - 1.85mm(m) to 1.85mm(f), right angle, Outline E
QAVWR-FF - 1.85mm(f) to 1.85mm(f), right angle, Outline F
QAVWL-FF - 1.85mm(f) to 1.85mm(f), flange mount, Outline G
QAVWH-FF - 1.85mm(f) to 1.85mm(f), bulk head, Outline H

Customization is available upon request.

Environmental

Temperature: -55~+125°C

Outline Drawings

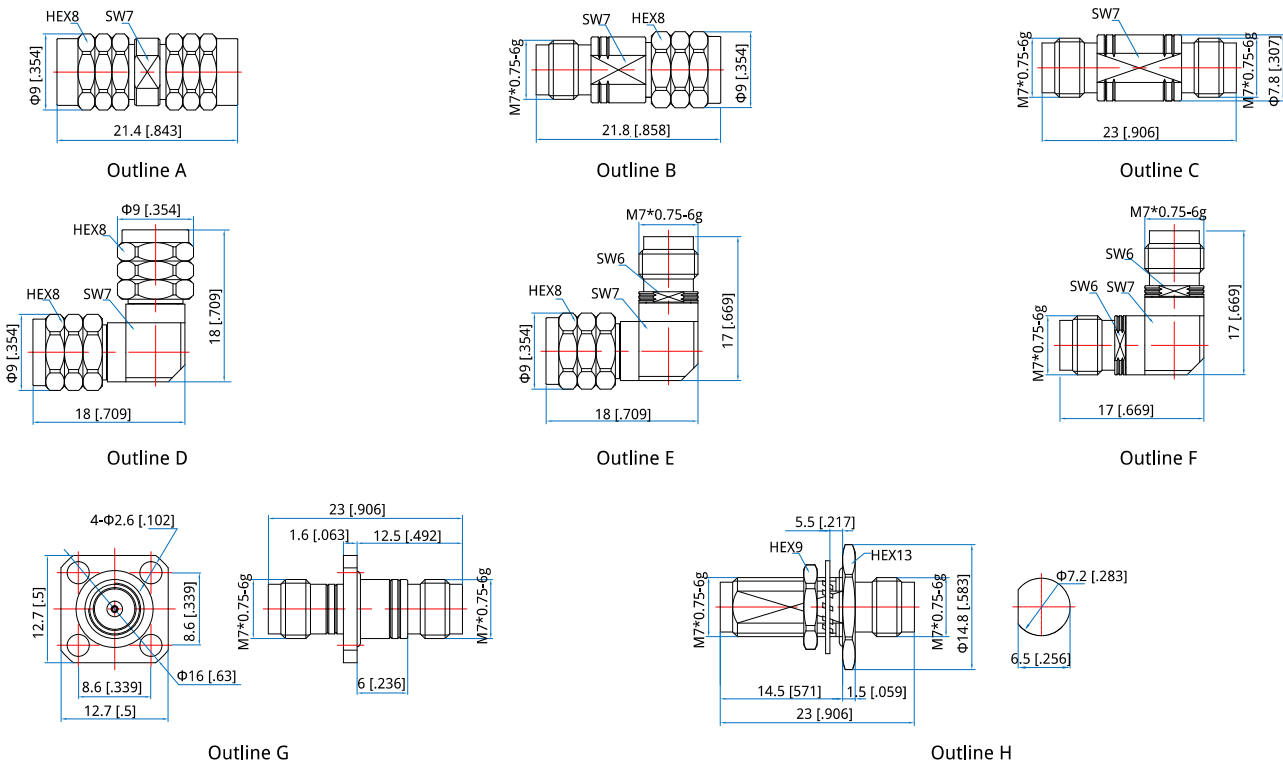

Unit: mm [in] Tolerance: $\pm 0.2\text{mm}$ [$\pm 0.008\text{in}$]

QA22 2.4mm to 2.4mm

Features:
* Low VSWR

Applications:
* Wireless
* Transmitter
* Laboratory Test
* Radar

Electrical

Frequency: DC~50GHz
VSWR: 1.25 max.
Impedance: 50Ω

Mechanical

RF Connectors: 2.4mm
Mating Life Cycle: 500 cycles
Outer Conductor: Passivated stainless steel
Dielectric: PEI
Inner Conductor: Gold plated beryllium copper or gold plated brass

How To Order

- QA22-MM** - 2.4mm(m) to 2.4mm(m), Outline A
- QA22-MF** - 2.4mm(m) to 2.4mm(f), Outline B
- QA22-FF** - 2.4mm(f) to 2.4mm(f), Outline C
- QA22R-MM** - 2.4mm(m) to 2.4mm(m), right angle, Outline D
- QA22R-MF** - 2.4mm(m) to 2.4mm(f), right angle, Outline E
- QA22L-FF** - 2.4mm(f) to 2.4mm(f), flange mount, Outline G
- QA22H-FF** - 2.4mm(f) to 2.4mm(f), bulk head, Outline H

Customization is available upon request.

Environmental

Temperature: -60~+165°C

Outline Drawings

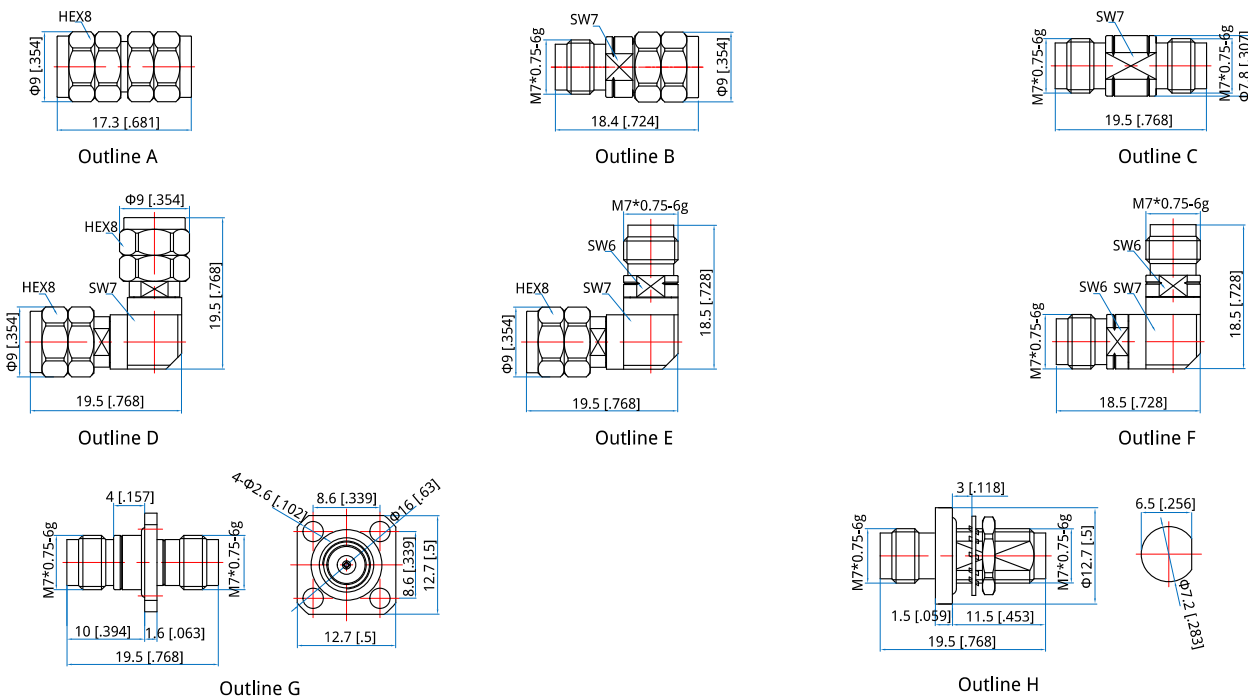

Unit: mm [in] Tolerance: ±0.2mm [±0.008in]

QAKK 2.92mm to 2.92mm

Features:
* Low VSWR

Applications:
* Wireless
* Transmitter
* Laboratory Test
* Radar

Electrical

Frequency: DC~40GHz
VSWR: 1.25 max.
Impedance: 50Ω

Mechanical

RF Connectors: 2.92mm
Mating Life Cycle: 500 cycles
Outer Conductor: Passivated Stainless Steel
Dielectric: PEI
Inner Conductor: Gold Plated Beryllium Copper

Environmental

Temperature: -60~+165°C

How To Order

- QAKK-MM** - 2.92mm (m) to 2.92mm (m), Outline A
- QAKK-MF** - 2.92mm (m) to 2.92mm (f), Outline B
- QAKK-FF** - 2.92mm (f) to 2.92mm (f), Outline C
- QAKKR-MM**-2.92mm (m) to 2.92mm (m) right angle, Outline D
- QAKKR-MF** - 2.92mm (m) to 2.92mm (f) right angle, Outline E
- QAKKR-FF** - 2.92mm (f) to 2.92mm (f) right angle, Outline F
- QAKKL-FF** - 2.92mm (f) to 2.92mm (f) flange mount, Outline G
- QAKKH-FF** - 2.92mm (f) to 2.92mm (f) bulk head, Outline H

Customization is available upon request.

Outline Drawings

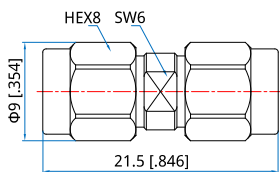

Outline A

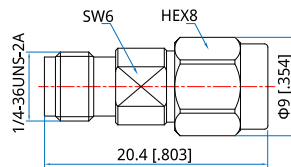

Outline B

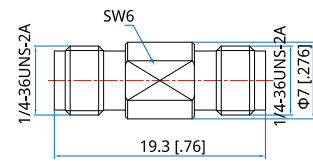

Outline C

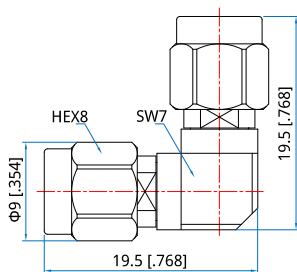

Outline D

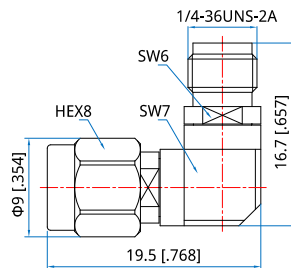

Outline E

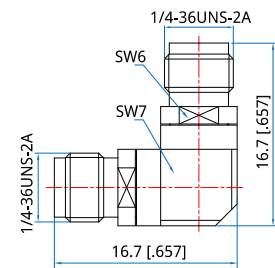

Outline F

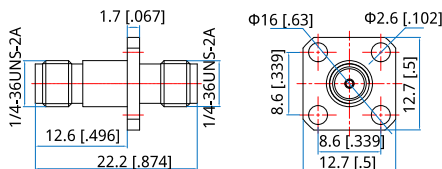

Outline G

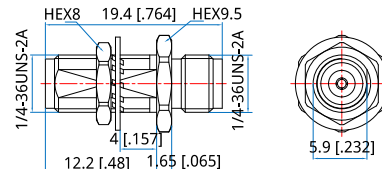

Outline H

Unit: mm [in] Tolerance: ±0.2mm [±0.008in]

QA33 3.5mm to 3.5mm

Features:
* Low VSWR

Applications:
* Wireless
* Transmitter
* Laboratory Test
* Radar

Electrical

Frequency:	DC~33GHz
VSWR:	1.15 max. 1.25 max. (bulk head) 1.25 max. (right angle)
Impedance:	50Ω

Mechanical

RF Connectors:	3.5mm
Outer Conductor:	Passivated stainless steel
Dielectric:	PEI
Inner Conductor:	Gold plated beryllium copper or gold plated brass

Environmental

Temperature: -55~+125°C

How To Order

- QA33-MM** - 3.5mm(m) to 3.5mm(m), Outline A
- QA33-MF** - 3.5mm(m) to 3.5mm(f), Outline B
- QA33-FF** - 3.5mm(f) to 3.5mm(f), Outline C
- QA33R-MM** - 3.5mm(m) to 3.5mm(m), right angle, Outline D
- QA33R-MF** - 3.5mm(m) to 3.5mm(f), right angle, Outline E
- QA33R-FF** - 3.5mm(f) to 3.5mm(f), right angle, Outline F
- QA33L-FF** - 3.5mm(f) to 3.5mm(f) flange mount, Outline G
- QA33H-FF** - 3.5mm(f) to 3.5mm(f) bulk head, Outline H

Customization is available upon request.

Outline Drawings

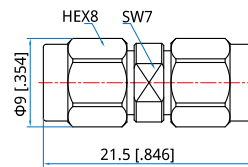

Outline A

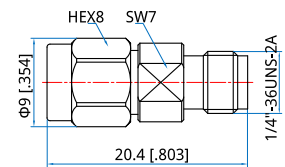

Outline B

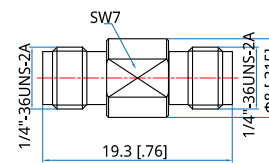

Outline C

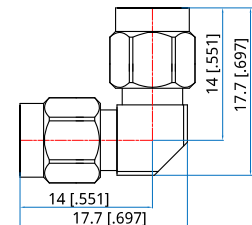

Outline D

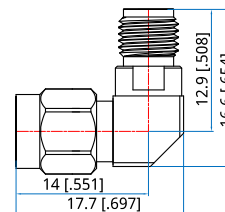

Outline E

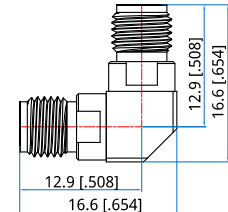

Outline F

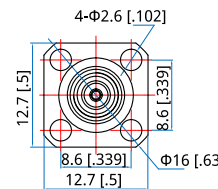

Outline G

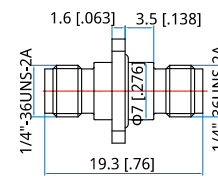

Outline H

Unit: mm [in]
Tolerance: ±0.2mm [±0.008in]

QAAA SSMA to SSMA

Features:
* Low VSWR

Applications:
* Wireless
* Transmitter
* Laboratory Test
* Radar

Electrical

Frequency: DC~26.5GHz
VSWR: 1.2 max.
Impedance: 50Ω

Mechanical

RF Connectors: SSMA
Mating Life Cycle: 500 cycles
Outer Conductor: Passivated stainless steel
Dielectric: PTFE
Inner Conductor: Gold plated beryllium copper

Environmental

Temperature: -55~+165°C

Outline Drawings

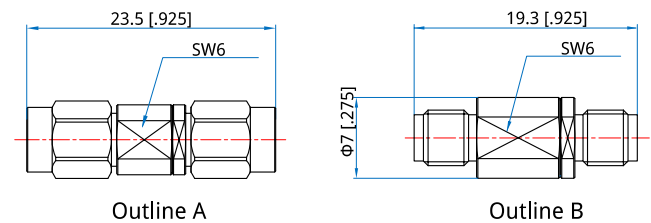

Unit: mm [in]
Tolerance: ±0.2mm [±0.008in]

How To Order

QAAA-MM - SSMA(m) to SSMA(m), Outline A

QAAA-FF - SSMA(f) to SSMA(f), Outline B

Customization is available upon request.

QASS SMA to SMA

Features:
* Low VSWR

Applications:
* Wireless
* Transmitter
* Laboratory Test
* Radar



Electrical

Frequency:	DC~26.5GHz DC~18GHz (right angle, bulk head)
VSWR:	1.2 max.
VSWR (bulk head):	1.25 max.
VSWR (Right Angle):	1.3 max.
Impedance:	50Ω

Mechanical

RF Connectors:	SMA
Mating Life Cycle:	500 cycles
Outer Conductor:	Passivated Stainless Steel or Gold plated brass
Dielectric:	PEI or PTFE
Inner Conductor:	Gold Plated Beryllium Copper

Environmental

Temperature: -55~+85°C

How To Order

- QASS-MM** - SMA(m) to SMA(m), Outline A
- QASS-MF** - SMA(m) to SMA(f), Outline B
- QASS-FF** - SMA(f) to SMA(f), Outline C
- QASSR-MM** - SMA(m) to SMA(m) right angle, Outline D
- QASSR-MF** - SMA(m) to SMA(f) right angle, Outline E
- QASSR-FF** - SMA(f) to SMA(f) right angle, Outline F
- QASSH-FF** - SMA(f) to SMA(f) bulk head, Outline G
- QASSL-FF** - SMA(f) to SMA(f) flange mount, Outline H

Customization is available upon request.

Outline Drawings

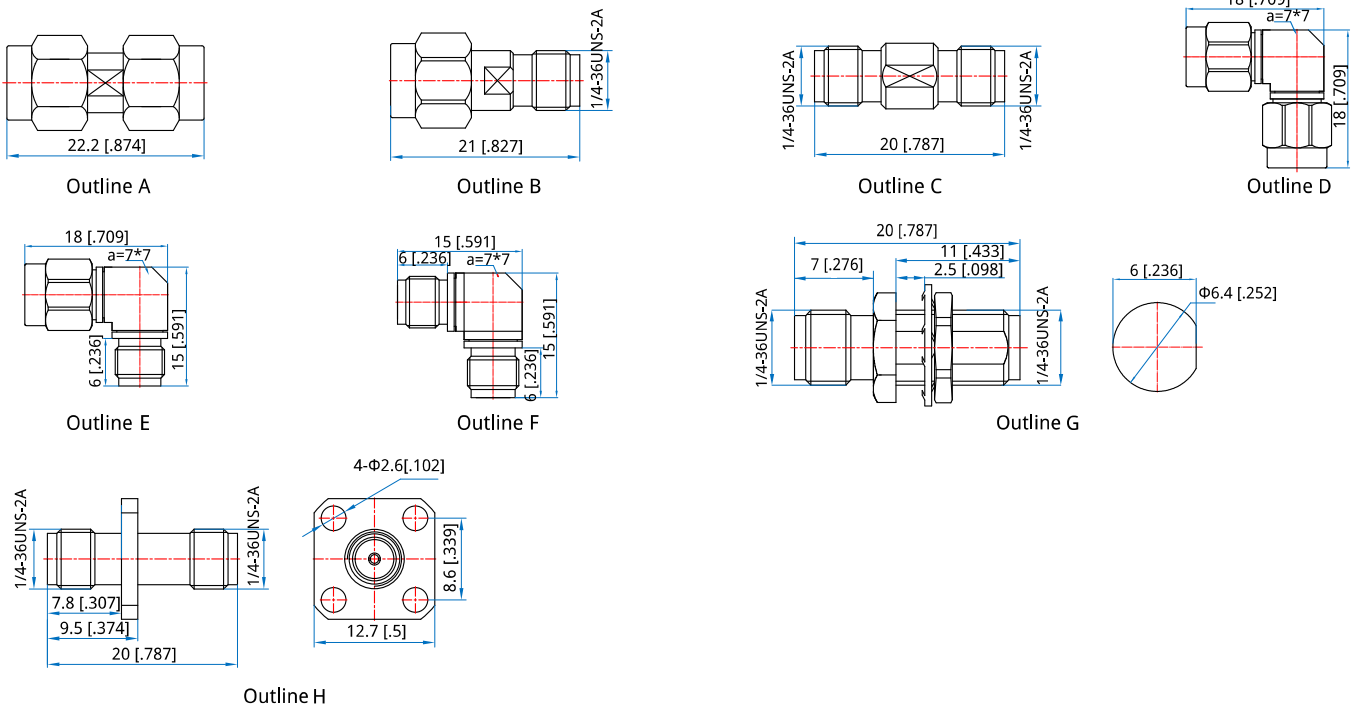

Unit: mm [in] Tolerance: ±0.2mm [±0.008in]

QASS-A SMA to SMA

Features:
* Low VSWR

Applications:
* Wireless
* Transmitter
* Laboratory Test
* Radar

Electrical

Frequency: DC~26.5GHz
DC~18GHz (Right angle)
VSWR: 1.2 max.
Impedance: 50Ω

Mechanical

RF Connectors: SMA
Mating Life Cycle: 500 cycles
Outer Conductor: Passivated stainless steel
Dielectric: PTFE
Inner Conductor: Gold plated beryllium copper or gold plated brass

How To Order

QASS-MM-A - SMA(m) to SMA(m), Outline A
QASS-MF-A - SMA(m) to SMA(f), Outline B
QASS-FF-A - SMA(f) to SMA(f), Outline C
QASSR-MM-A - SMA(m) to SMA(m) right angle, Outline D
QASSR-MF-A - SMA(m) to SMA(f) right angle, Outline E
QASSH-MF-A - SMA(m) to SMA(f) bulk head, Outline G
QASSH-FF-A - SMA(f) to SMA(f) bulk head, Outline H
QASSL-FF-A - SMA(f) to SMA(f) flange mount, Outline I

Customization is available upon request.

Environmental

Temperature: -55~+85°C

Outline Drawings

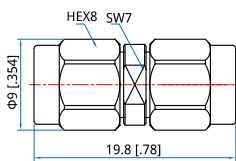

Outline A

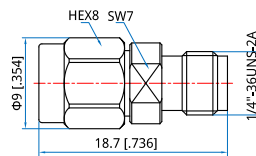

Outline B

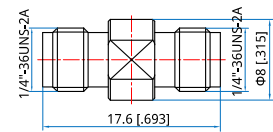

Outline C

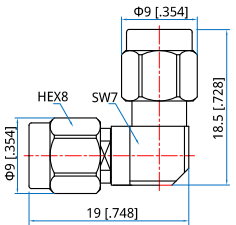

Outline D

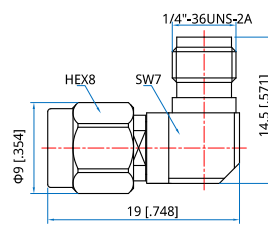

Outline E

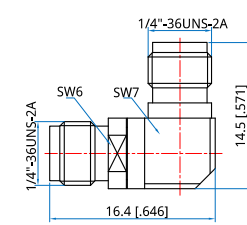

Outline F

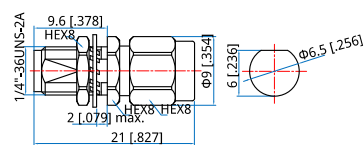

Outline G

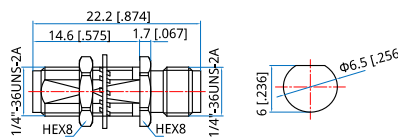

Outline H

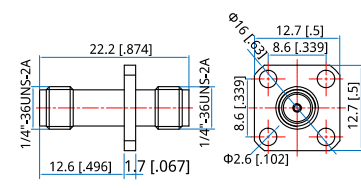

Outline I

Unit: mm [in] Tolerance: ±0.2mm [±0.008in]

QASS-B SMA to SMA

Features:
* Low VSWR

Applications:
* Wireless
* Transmitter
* Laboratory Test
* Radar

Electrical

Frequency: DC~26.5GHz
DC~18GHz (Right angle)
VSWR: 1.2 max.
Impedance: 50Ω

Mechanical

RF Connectors: SMA
Mating Life Cycle: 500 cycles
Outer Conductor: Gold plated brass
Dielectric: PTFE
Inner Conductor: Gold plated brass or Gold plated beryllium copper

How To Order

- QASS-MM-B** - SMA(m) to SMA(m), Outline A
- QASS-MF-B** - SMA(m) to SMA(f), Outline B
- QASS-FF-B** - SMA(f) to SMA(f), Outline C
- QASSR-MM-B** - SMA(m) to SMA(m), Right angle, Outline D
- QASSR-MF-B** - SMA(m) to SMA(f), Right angle, Outline E
- QASSR-FF-B** - SMA(f) to SMA(f), Right angle, Outline F
- QASSL-MF-B** - SMA(m) to SMA(f), Flange mount, Outline G
- QASSL-FF-B** - SMA(f) to SMA(f), Flange mount, Outline H
- QASSH-FF-B** - SMA(f) to SMA(f), Bulk head, Outline I

Customization is available upon request.

Environmental

Temperature: -55~+85°C

Outline Drawings

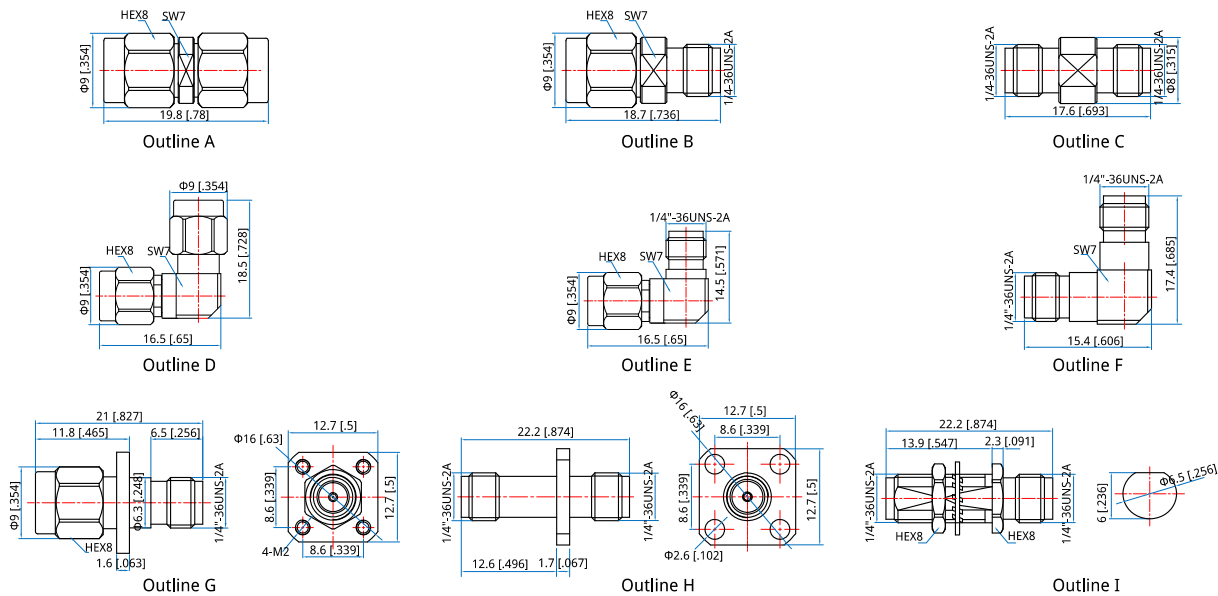

Unit: mm [in]

Tolerance: ±0.2mm [±0.008in]

QANN N to N

Features:
* Low VSWR

Applications:
* Wireless
* Transmitter
* Laboratory Test
* Radar

Electrical

Frequency:	DC~18GHz
VSWR:	1.15 max. 1.2 max. @flange mount
Insertion Loss:	0.45dB max.
Impedance:	50Ω

Mechanical

RF Connectors:	N
Outer Conductor:	Passivated stainless steel
Dielectric:	PTFE or PEI
Inner Conductor:	Gold plated brass or gold plated beryllium copper

Environmental

Temperature: -55~+85°C

How To Order

- QANN-MM** - N (m) to N (m), Outline A
- QANN-MF** - N (m) to N (f), Outline B
- QANN-FF** - N (f) to N (f), Outline C
- QANNR-MM** - N (m) to N (m), right angle, Outline D
- QANNR-MF** - N (m) to N (f), right angle, Outline E
- QANNR-FF** - N (f) to N (f), right angle, Outline F
- QANNH-FF** - N (f) to N (f), bulk head, Outline G
- QANNL-FF** - N (f) to N (f), flange mount, Outline H

Customization is available upon request.

Outline Drawings

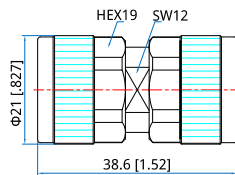

Outline A

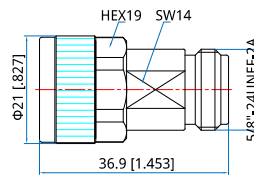

Outline B

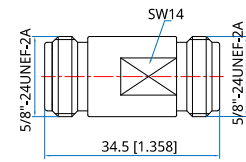

Outline C

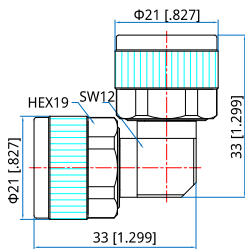

Outline D

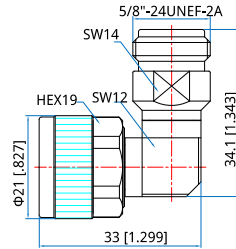

Outline E

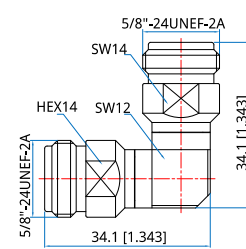

Outline F

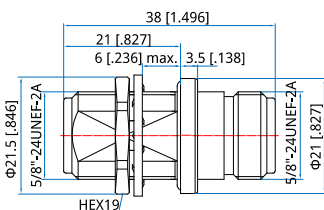

Outline G

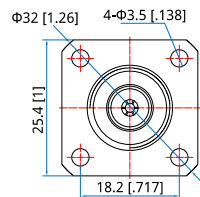
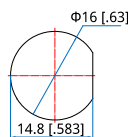

Outline H

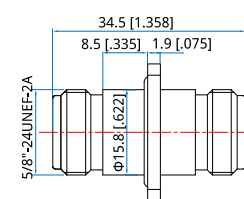

Unit: mm [in] Tolerance: ±0.2mm [±0.008in]

QATT TNC to TNC

Features:
* Low VSWR

Applications:
* Wireless
* Transmitter
* Laboratory Test
* Radar

Electrical

Frequency:	0.01~18GHz DC~11GHz (bulk head) DC~18GHz(right angle)
VSWR:	1.2 max.
VSWR (bulk head):	1.25 max.
VSWR (Right Angle):	1.5 max.
Impedance:	50Ω

Mechanical

RF Connectors:	TNC
Outer Conductor:	Passivated SUS303 Stainless Steel
Dielectric:	PTFE PEI&PTFE(QATT-MF)
Inner Conductor:	Gold Plated Beryllium Copper

Environmental

Temperature:	-50~+85°C
--------------	-----------

How To Order

QATT-MM - TNC(m) to TNC(m), Outline A

QATT-MF - TNC(m) to TNC(f), Outline B

QATT-FF - TNC(f) to TNC(f), Outline C

QATTR-MF - TNC(m) to TNC(f), right angle, Outline D

QATTH-FF - TNC(f) to TNC(f), bulk head, Outline E

Customization is available upon request.

Outline Drawings

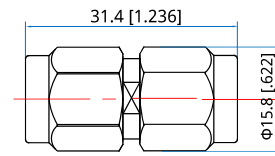

Outline A

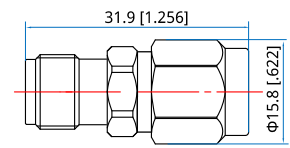

Outline B

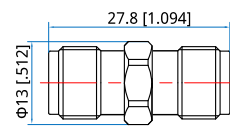

Outline C

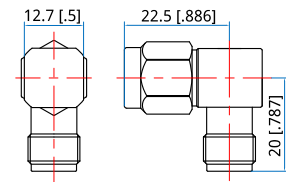

Outline D

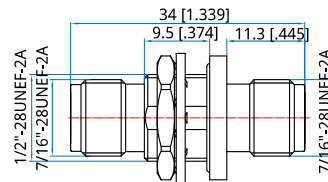

Outline E

Unit: mm [in]
Tolerance: ±0.2mm [±0.008in]

QA77

7/16(DIN) to 7/16(DIN)

Features:
* Low VSWR

Applications:
* Wireless
* Transmitter
* Laboratory Test
* Radar

Electrical

Frequency: DC~7.5GHz
VSWR: 1.2 max.
Impedance: 50Ω

Mechanical

RF Connectors: 7/16 DIN
Outer Conductor: Ternary plated brass
Dielectric: PTFE
Inner Conductor: Silver plated beryllium copper

Environmental

Temperature: -55~+165°C

How To Order

QA77-MF - 7/16 DIN(f) to 7/16 DIN(m), Outline A

QA77-MM - 7/16 DIN(m) to 7/16 DIN(m), Outline B

QA77-FF - 7/16 DIN(f) to 7/16 DIN(f), Outline C

QA77H-FF - 7/16 DIN(f) to 7/16 DIN(f), Outline D

Customization is available upon request.

Outline Drawings

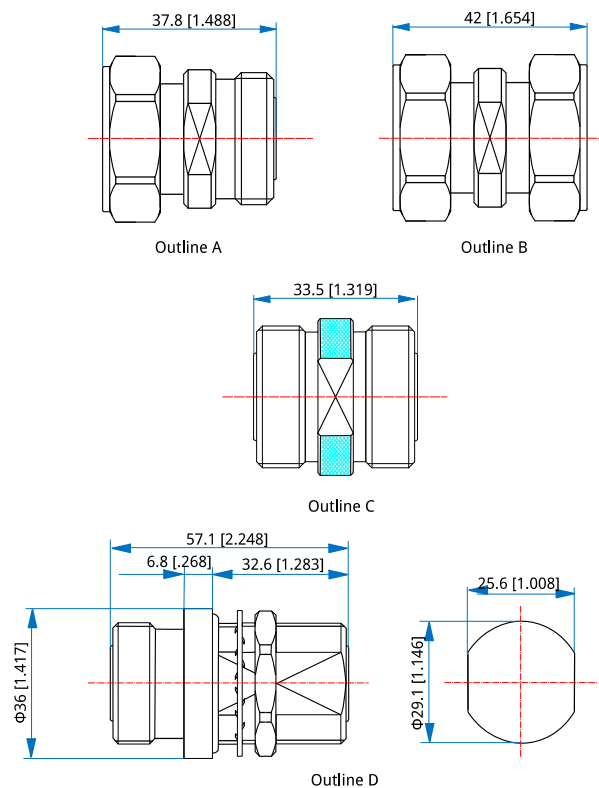

Unit: mm [in]

Tolerance: ± 0.2 mm [± 0.008 in]

QAEE SC to SC

Features:
* Low VSWR

Applications:
* Wireless
* Transmitter
* Laboratory Test
* Radar

Electrical

Frequency: DC-6GHz
VSWR: 1.25 max.
Impedance: 50Ω

Mechanical

RF Connectors: SC
Mating Life Cycle: 500 cycles
Outer Conductor: Nickel Plated Brass or SUS303
Stainless Steel
Dielectric: PTFE
Inner Conductor: Gold Plated Tin-phosphor
Bronze

Environmental

Temperature: -55~+85°C

Outline Drawings

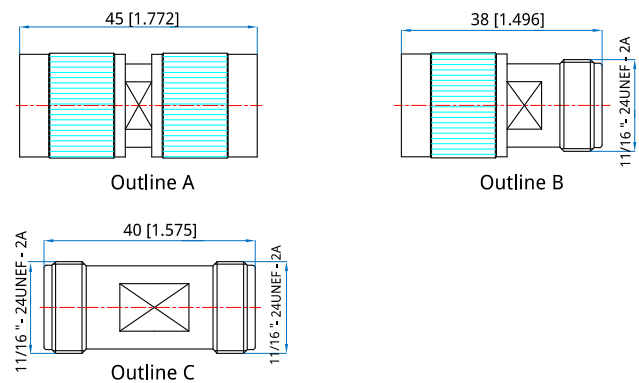

Unit: mm [in]

Tolerance: ±0.2mm [±0.008in]

How To Order

QAEE-MM - SC(m) to SC(m), Outline A

QAEE-MF - SC(m) to SC(f), Outline B

QAEE-FF - SC(f) to SC(f), Outline C

Customization is available upon request.

QA1V

1.0mm to 1.85mm

Features:
* Low VSWR

Applications:
* Wireless
* Transmitter
* Laboratory Test
* Radar

Electrical

Frequency:	DC~67GHz
VSWR:	1.3 max.
Insertion Loss:	0.5dB max.
Impedance:	50Ω

Mechanical

RF Connectors:	1.0mm 1.85mm
Mating Life Cycle:	500 cycles
Outer Conductor:	Passivated Stainless Steel
Dielectric:	PEI
Inner Conductor:	Gold Plated Beryllium Copper

Environmental

Temperature:	-55~+165°C
--------------	------------

Outline Drawings

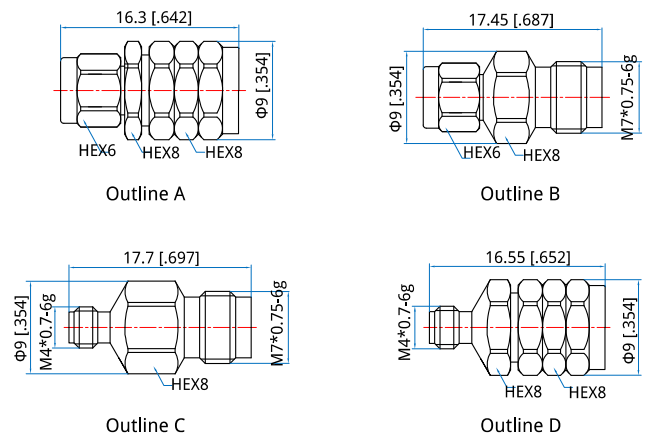

Unit: mm [in]

Tolerance: ±0.2mm [±0.008in]

How To Order

QA1V-MM - 1.0mm(m) to 1.85mm(m), Outline A

QA1V-MF - 1.0mm(m) to 1.85mm(f), Outline B

QA1V-FF - 1.0mm(f) to 1.85mm(f), Outline C

QA1V-FM - 1.0mm(f) to 1.85mm(m), Outline D

Customization is available upon request.

QAV2

1.85mm to 2.4mm

Features:
* Low VSWR

Applications:
* Wireless
* Transmitter
* Laboratory Test
* Radar

Electrical

Frequency: DC~50GHz
VSWR: 1.2 max.
1.3 max. (right angle)
Impedance: 50Ω

Mechanical

RF Connectors: 1.85mm
2.4mm
Mating Life Cycle: 500 cycles
Outer Conductor: Passivated Stainless Steel
Dielectric: PEI
Inner Conductor: Gold Plated Beryllium Copper

Environmental

Temperature: -55~+165°C

How To Order

- QAV2-MM** - 1.85mm(m) to 2.4mm(m), Outline A
- QAV2-MF** - 1.85mm(m) to 2.4mm(f), Outline B
- QAV2-FM** - 1.85mm(f) to 2.4mm(m), Outline C
- QAV2-FF** - 1.85mm(f) to 2.4mm(f), Outline D
- QAV2R-MM** - 1.85mm(m) to 2.4mm(m), right angle, Outline E
- QAV2R-MF** - 1.85mm(m) to 2.4mm(f), right angle, Outline F
- QAV2R-FM** - 1.85mm(f) to 2.4mm(m), right angle, Outline G
- QAV2R-FF** - 1.85mm(f) to 2.4mm(f), right angle, Outline H

Customization is available upon request.

Outline Drawings

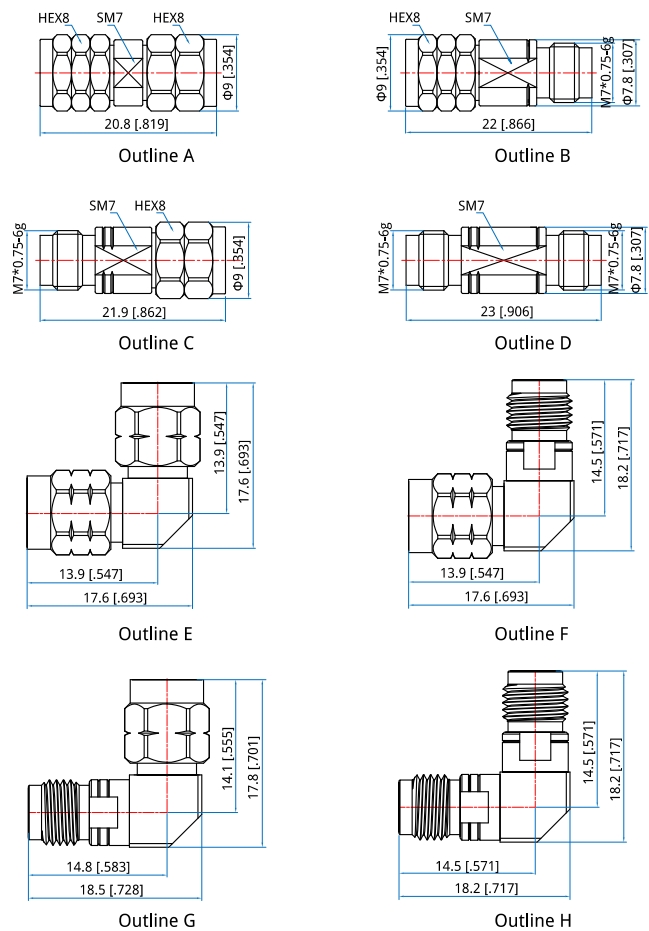

Unit: mm [in]

Tolerance: $\pm 0.2\text{mm}$ [$\pm 0.008\text{in}$]

QAVK 1.85mm to 2.92mm

Features:
* Low VSWR

Applications:
* Wireless
* Transmitter
* Laboratory Test
* Radar

Electrical

Frequency:	DC~40GHz
VSWR:	1.15 max. 1.25 max. (right angle)
Insertion Loss:	0.26dB max. 0.4dB max. (right angle)
Impedance:	50Ω

Mechanical

RF Connectors:	1.85mm 2.92mm
Mating Life Cycle:	500 cycles
Outer Conductor:	Passivated Stainless Steel
Dielectric:	PEI
Inner Conductor:	Gold Plated Beryllium Copper

Environmental

Temperature: -55~+165°C

How To Order

- QAVK-MM** - 1.85mm(m) to 2.92mm(m), Outline A
- QAVK-MF** - 1.85mm(m) to 2.92mm(f), Outline B
- QAVK-FM** - 1.85mm(f) to 2.92mm(m), Outline C
- QAVK-FF** - 1.85mm(f) to 2.92mm(f), Outline D
- QAVKR-MM** - 1.85mm(m) to 2.92mm(m), right angle, Outline E
- QAVKR-MF** - 1.85mm(m) to 2.92mm(f), right angle, Outline F
- QAVKR-FM** - 1.85mm(f) to 2.92mm(m), right angle, Outline G
- QAVKR-FF** - 1.85mm(f) to 2.92mm(f), right angle, Outline H

Customization is available upon request.

Outline Drawings

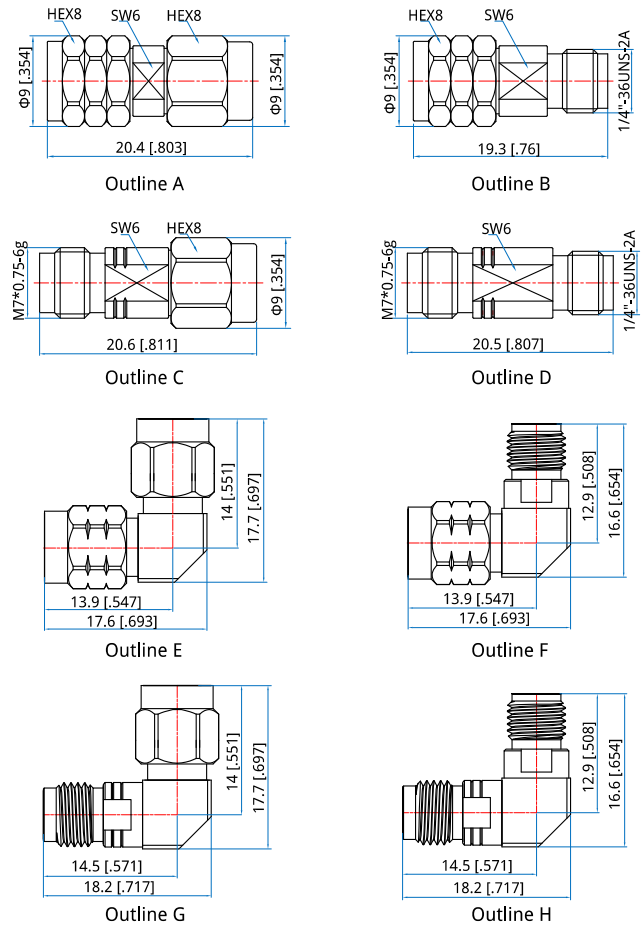

Unit: mm [in]
Tolerance: ±0.2mm [±0.008in]

QAG2

SSMP to 2.4mm

Features:
* Low VSWR

Applications:
* Wireless
* Transmitter
* Laboratory Test
* Radar

Electrical

Frequency: DC~40GHz
VSWR: 1.2 max.
Impedance: 50Ω

Mechanical

RF Connectors: SSMP
2.4mm
Mating Life Cycle: 500 cycles
Outer Conductor: Passivated SUS303 Stainless Steel
Dielectric: PEI
Inner Conductor: Gold Plated Beryllium Copper

Environmental

Temperature: -60~+165°C

Outline Drawings

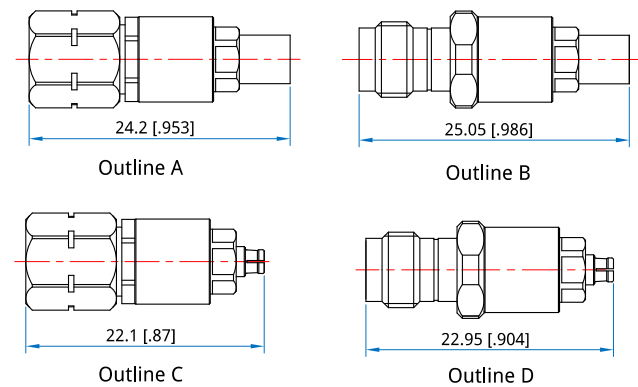

Unit: mm [in]

Tolerance: ±0.2mm [±0.008in]

How To Order

QAG2-MM - SSMP (m) to 2.4mm (m), Outline A

QAG2-MF - SSMP (m) to 2.4mm (f), Outline B

QAG2-FM - SSMP (f) to 2.4mm (m), Outline C

QAG2-FF - SSMP (f) to 2.4mm (f), Outline D

Customization is available upon request.

QAGK

SSMP to 2.92mm

Features:
* Low VSWR

Applications:
* Wireless
* Transmitter
* Laboratory Test
* Radar

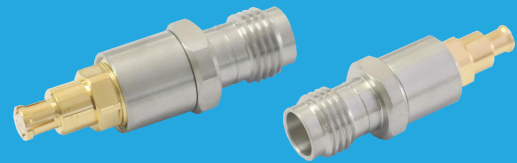

Electrical

Frequency: DC~40GHz
VSWR: 1.2 max.
Impedance: 50Ω

Mechanical

RF Connectors: SSMP
2.92mm
Mating Life Cycle: 500 cycles
Outer Conductor: Passivated SUS303 Stainless Steel
Dielectric: PEI
Inner Conductor: Gold Plated Beryllium Copper

Environmental

Temperature: -60~+165°C

Outline Drawings

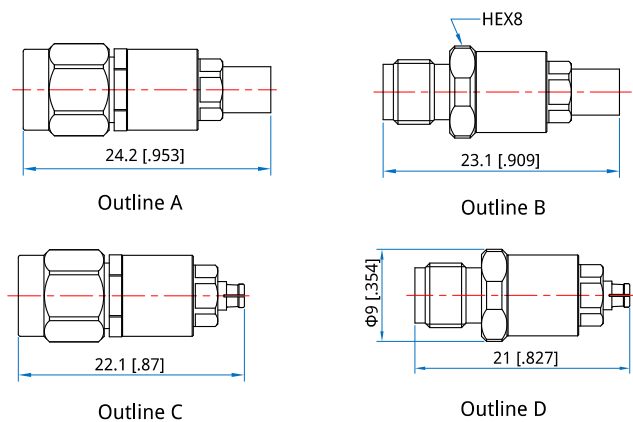

Unit: mm [in]

Tolerance: ±0.2mm [±0.008in]

How To Order

QAGK-MM - SSMP (m) to 2.92mm (m), Outline A

QAGK-MF - SSMP (m) to 2.92mm (f), Outline B

QAGK-FM - SSMP (f) to 2.92mm (m), Outline C

QAGK-FF - SSMP (f) to 2.92mm (f), Outline D

Customization is available upon request.

QA2K 2.4mm to 2.92mm

Features:
* Low VSWR

Applications:
* Wireless
* Transmitter
* Laboratory Test
* Radar

Electrical

Frequency: DC~40GHz
VSWR: 1.25 max.
Impedance: 50Ω

Mechanical

RF Connectors: 2.4mm
2.92mm
Mating Life Cycle: 500 cycles
Outer Conductor: Passivated stainless steel
Dielectric: PEI or PTFE
Inner Conductor: Gold plated beryllium copper
or gold plated brass

Environmental

Temperature: -60~+165°C

How To Order

- QA2K-MM** - 2.4mm(m) to 2.92mm(m), Outline A
- QA2K-MF** - 2.4mm(m) to 2.92mm(f), Outline B
- QA2K-FM** - 2.4mm(f) to 2.92mm(m), Outline C
- QA2K-FF** - 2.4mm(f) to 2.92mm(f), Outline D
- QA2KR-MM** - 2.4mm(m) to 2.92mm(m), right angle, Outline E
- QA2KR-MF** - 2.4mm(m) to 2.92mm(f), right angle, Outline F
- QA2KR-FM** - 2.4mm(f) to 2.92mm(m), right angle, Outline G
- QA2KR-FF** - 2.4mm(f) to 2.92mm(f), right angle, Outline H

Customization is available upon request.

Outline Drawings

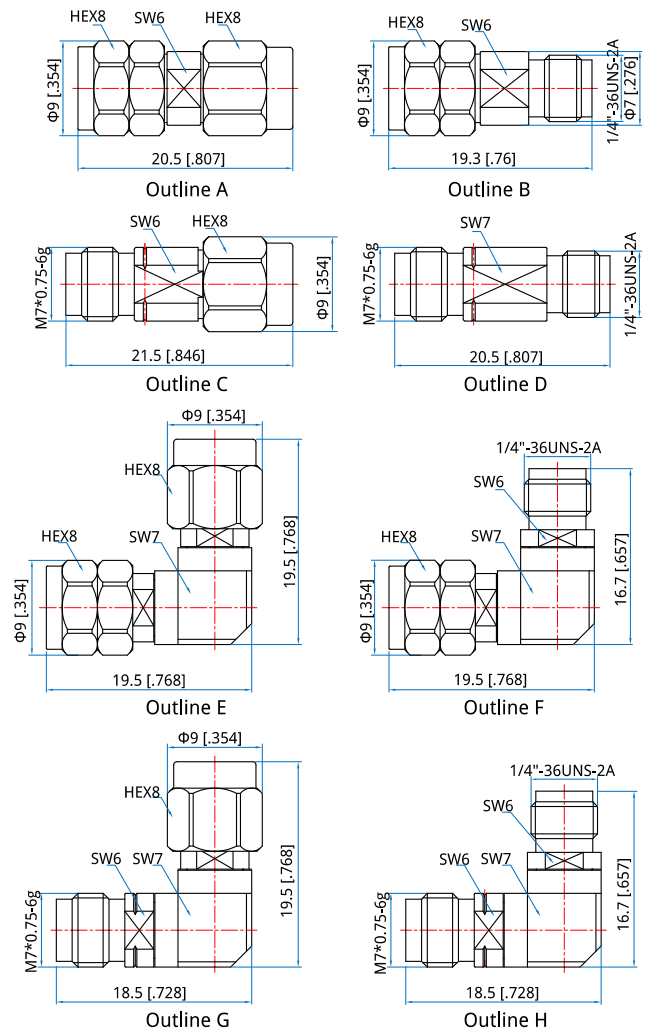

Unit: mm [in]
Tolerance: ±0.2mm [±0.008in]

QA2P

2.4mm to SMP

Features:
* Low VSWR

Applications:
* Wireless
* Transmitter
* Laboratory Test
* Radar

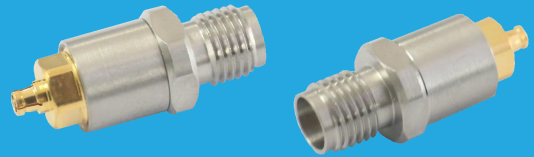

Electrical

Frequency: DC~40GHz
VSWR: 1.5 max.
Impedance: 50Ω

Mechanical

RF Connectors: 2.4mm
SMP
Mating Life Cycle: 500 cycles
Outer Conductor: Passivated Stainless Steel
Dielectric: PEI
Inner Conductor: Gold Plated Beryllium Copper

Environmental

Temperature: -50~+85°C

Outline Drawings

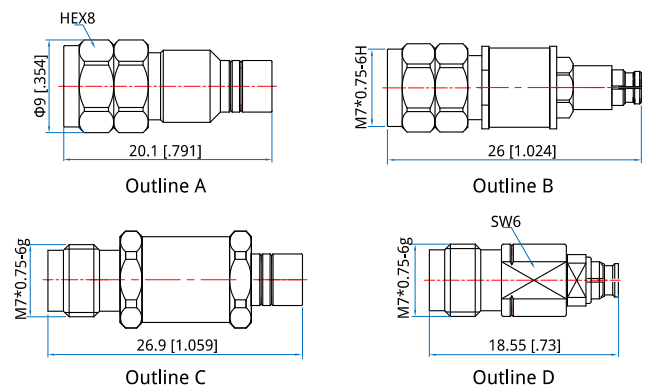

Unit: mm [in]

Tolerance: ±0.2mm [±0.008in]

How To Order

QA2P-MM - 2.4mm (m) to SMP (m), Outline A

QA2P-MF - 2.4mm (m) to SMP (f), Outline B

QA2P-FM - 2.4mm (f) to SMP (m), Outline C

QA2P-FF - 2.4mm (f) to SMP (f), Outline D

Customization is available upon request.

QAKA

2.92mm to SSMA

Features:
* Low VSWR

Applications:
* Wireless
* Transmitter
* Laboratory Test
* Radar

Electrical

Frequency:	DC~40GHz
VSWR:	1.2 max.
Insertion Loss:	0.26dB max.
Impedance:	50Ω

Mechanical

RF Connectors:	2.92mm SSMA
Mating Life Cycle:	500 cycles
Outer Conductor:	Passivated stainless steel
Dielectric:	PEI
Inner Conductor:	Gold plated beryllium copper

Environmental

Temperature:	-55~+125°C
--------------	------------

Outline Drawings

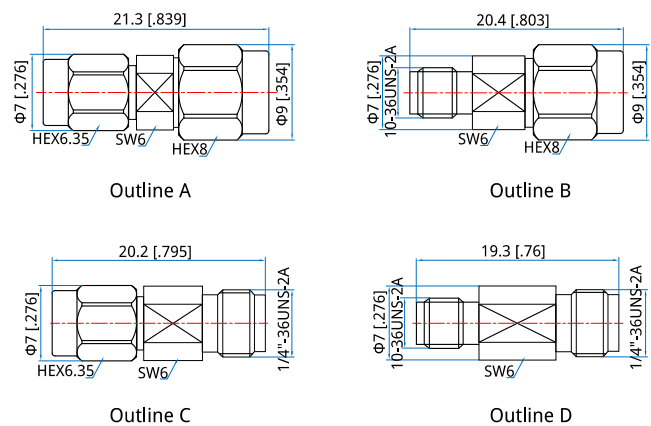

Unit: mm [in]
Tolerance: ±0.2mm [±0.008in]

How To Order

QAKA-MM - 2.92mm(m) to SSMA(m), Outline A

QAKA-MF - 2.92mm(m) to SSMA(f), Outline B

QAKA-FM - 2.92mm(f) to SSMA(m), Outline C

QAKA-FF - 2.92mm(f) to SSMA(f), Outline D

Customization is available upon request.

QAKP 2.92mm to SMP

Features:
* Low VSWR

Applications:
* Wireless
* Transmitter
* Laboratory Test
* Radar

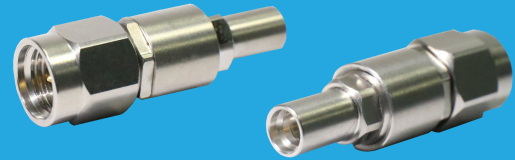

Electrical

Frequency: DC~40GHz
VSWR: 1.25 max.
Impedance: 50Ω

Mechanical

RF Connectors: 2.92mm
SMP
Mating Life Cycle: 500 cycles
Outer Conductor: SUS303 Stainless Steel, Gold
Plated Beryllium Copper
Dielectric: PEI
Inner Conductor: Gold Plated Beryllium Copper

Environmental

Temperature: -60~+165°C

How To Order

- QAKP-MM** - 2.92mm (m) to SMP (m), Outline A
- QAKP-MF** - 2.92mm (m) to SMP (f), Outline B
- QAKP-FM** - 2.92mm (f) to SMP (m), Outline C
- QAKP-FF** - 2.92mm (f) to SMP (f), Outline D
- QAKPL-FM** - 2.92mm (f) to SMP (m), flange mount, Outline E

Customization is available upon request.

Outline Drawings

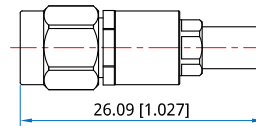

Outline A

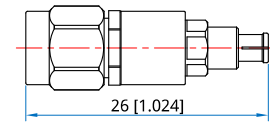

Outline B

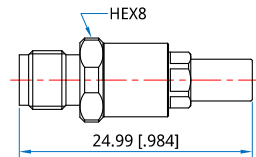

Outline C

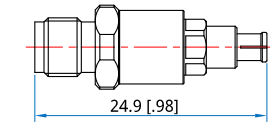

Outline D

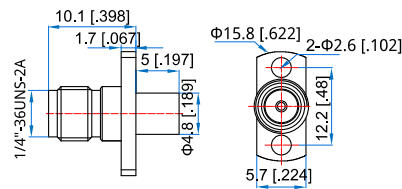

Outline E

Unit: mm [in]
Tolerance: ±0.2mm [±0.008in]

QAV3 1.85mm to 3.5mm

Features:
* Low VSWR

Applications:
* Wireless
* Transmitter
* Laboratory Test
* Radar



Electrical

Frequency: DC~33GHz
VSWR: 1.15 max.
1.25 max. (right angle)
Impedance: 50Ω

Mechanical

RF Connectors: 1.85mm
3.5mm
Mating Life Cycle: 500 cycles
Outer Conductor: Passivated Stainless Steel
Dielectric: PEI
Inner Conductor: Gold Plated Beryllium Copper

Environmental

Temperature: -55~+125°C

How To Order

- QAV3-MM** - 1.85mm(m) to 3.5mm(m), Outline A
- QAV3-MF** - 1.85mm(m) to 3.5mm(f), Outline B
- QAV3-FM** - 1.85mm(f) to 3.5mm(m), Outline C
- QAV3-FF** - 1.85mm(f) to 3.5mm(f), Outline D
- QAV3R-MM** - 1.85mm(m) to 3.5mm(m), right angle, Outline E
- QAV3R-MF** - 1.85mm(m) to 3.5mm(f), right angle, Outline F
- QAV3R-FM** - 1.85mm(f) to 3.5mm(m), right angle, Outline G
- QAV3R-FF** - 1.85mm(f) to 3.5mm(f), right angle, Outline H

Customization is available upon request.

Outline Drawings

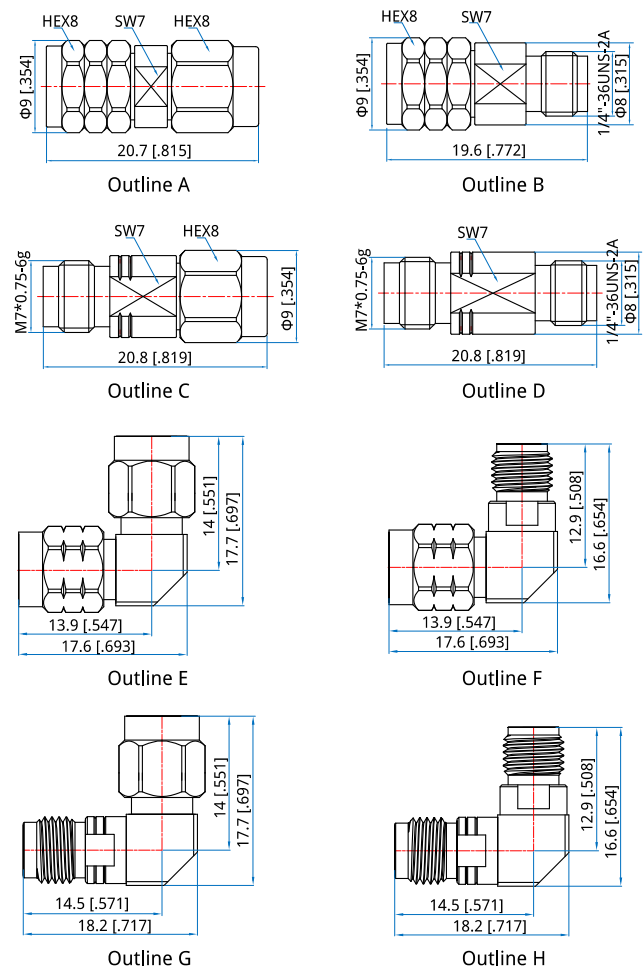

Unit: mm [in]
Tolerance: ±0.2mm [±0.008in]

QA23 2.4mm to 3.5mm

Features:
* Low VSWR

Applications:
* Wireless
* Transmitter
* Laboratory Test
* Radar

Electrical

Frequency: DC~33GHz
VSWR: 1.15 max.
1.25 max. (right angle)
Impedance: 50Ω

Mechanical

RF Connectors: 2.4mm
3.5mm
Mating Life Cycle: 500 cycles
Outer Conductor: Passivated Stainless Steel
Dielectric: PEI
Inner Conductor: Gold Plated Beryllium Copper

Environmental

Temperature: -60~+165°C

How To Order

- QA23-MM** - 2.4mm (m) to 3.5mm (m), Outline A
- QA23-MF** - 2.4mm (m) to 3.5mm (f), Outline B
- QA23-FM** - 2.4mm (f) to 3.5mm (m), Outline C
- QA23-FF** - 2.4mm (f) to 3.5mm (f), Outline D
- QA23R-MM** - 2.4mm (m) to 3.5mm (m), right angle, Outline E
- QA23R-MF** - 2.4mm (m) to 3.5mm (f), right angle, Outline F
- QA23R-FM** - 2.4mm (f) to 3.5mm (m), right angle, Outline G
- QA23R-FF** - 2.4mm (f) to 3.5mm (f), right angle, Outline H

Customization is available upon request.

Outline Drawings

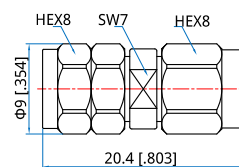

Outline A

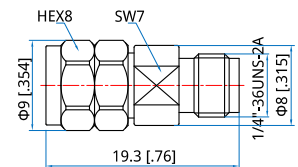

Outline B

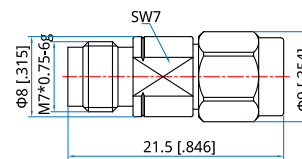

Outline C

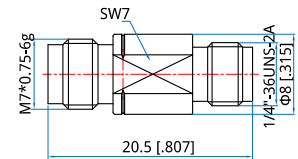

Outline D

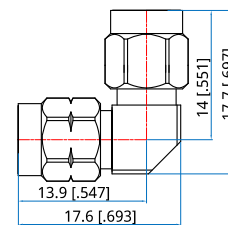

Outline E

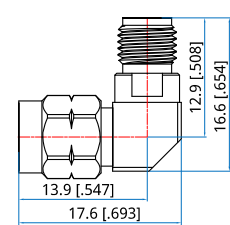

Outline F

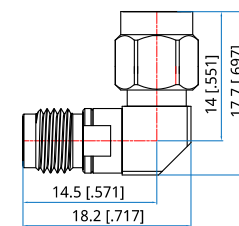

Outline G

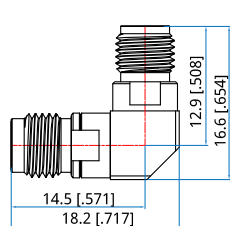

Outline H

Unit: mm [in]

Tolerance: ±0.2mm [±0.008in]

QAK3 2.92mm to 3.5mm

Features:
* Low VSWR

Applications:
* Wireless
* Transmitter
* Laboratory Test
* Radar

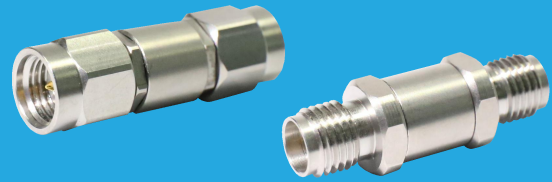

Electrical

Frequency: DC~33GHz
VSWR: 1.18 max.
1.25 max. (right angle)
Impedance: 50Ω

Mechanical

RF Connectors: 2.92mm
3.5mm
Mating Life Cycle: 500 cycles
Outer Conductor: Passivated Stainless Steel
Dielectric: PEI
Inner Conductor: Gold Plated Beryllium Copper

Environmental

Temperature: -55~+165°C

How To Order

- QAK3-MM** - 2.9mm (m) to 3.5mm (m), Outline A
- QAK3-FF** - 2.9mm (f) to 3.5mm (f), Outline B
- QAK3-MF** - 2.9mm (m) to 3.5mm (f), Outline C
- QAK3-FM** - 2.9mm (f) to 3.5mm (m), Outline D
- QAK3R-MM** - 2.9mm (m) to 3.5mm (m), right angle, Outline E
- QAK3R-MF** - 2.9mm (m) to 3.5mm (f), right angle, Outline F
- QAK3R-FM** - 2.9mm (f) to 3.5mm (m), right angle, Outline G
- QAK3R-FF** - 2.9mm (f) to 3.5mm (f), right angle, Outline H

Customization is available upon request.

Outline Drawings

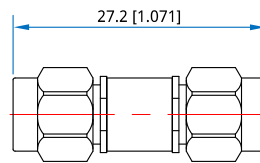

Outline A

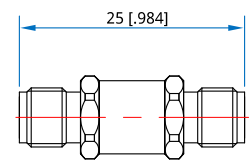

Outline B

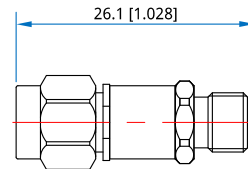

Outline C

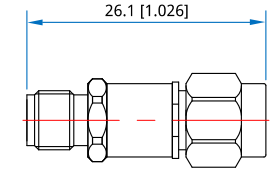

Outline D

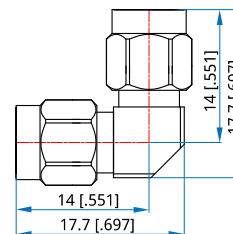

Outline E

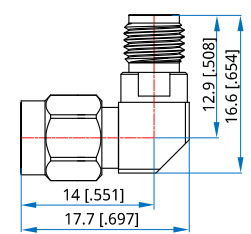

Outline F

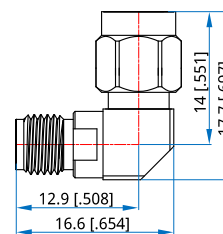

Outline G

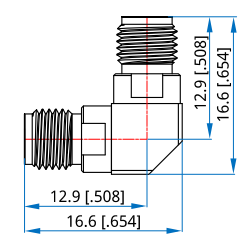

Outline H

Unit: mm [in]
Tolerance: ±0.2mm [±0.008in]

QAGS

SSMP to SMA

Features:
* Low VSWR

Applications:
* Wireless
* Transmitter
* Laboratory Test
* Radar

Electrical

Frequency: DC~26.5GHz
DC~18GHz (bulk head)
VSWR: 1.3 max.
Impedance: 50Ω

Mechanical

RF Connectors: SSMP
SMA
Outer Conductor: Passivated Stainless Steel or Gold plated brass
Dielectric: PTFE
Inner Conductor: Gold Plated Beryllium Copper

Environmental

Temperature: -55~+125°C

How To Order

- QAGS-FM** - SSMP(f) to SMA(m), Outline A
- QAGS-MM** - SSMP(m) to SMA(m), Outline B
- QAGS-FF** - SSMP(f) to SMA(f), Outline C
- QAGS-MF** - SSMP(m) to SMA(f), Outline D
- QAGSH-FF** - SSMP(f) to SMA(f), bulk head, Outline E

Customization is available upon request.

Outline Drawings

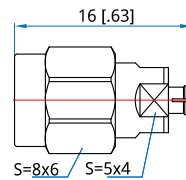

Outline A

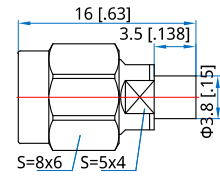

Outline B

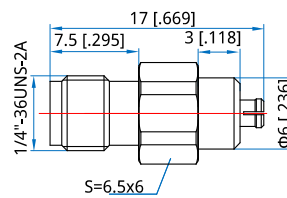

Outline C

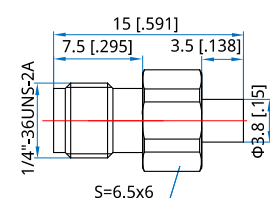

Outline D

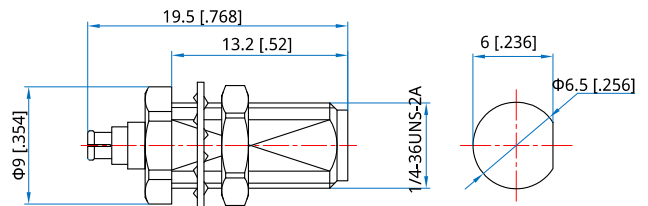

Outline E

Unit: mm [in]
Tolerance: ±0.2mm [±0.008in]

QAPS SMP to SMA

Features:
* Low VSWR

Applications:
* Wireless
* Transmitter
* Laboratory Test
* Radar

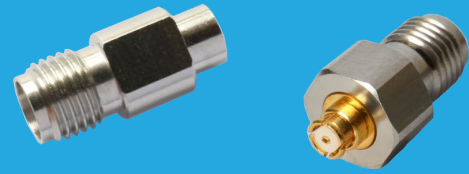

Electrical

Frequency:	DC~26.5GHz DC~18GHz (bulk head)
VSWR:	1.25 max.
Impedance:	50Ω

Mechanical

RF Connectors:	SMP SMA
Mating Life Cycle:	500 cycles
Outer Conductor:	Passivated Stainless Steel
Dielectric:	PTFE
Inner Conductor:	Gold Plated Beryllium Copper

Environmental

Temperature: -55~+85°C

How To Order

- QAPS-MM** - SMP(m) to SMA(m), Outline A
- QAPS-FF** - SMP(f) to SMA(f), Outline B
- QAPS-FM** - SMP(f) to SMA(m), Outline C
- QAPS-MF** - SMP(m) to SMA(f), Outline D
- QAPSH-MF** - SMP(m) to SMA(f) bulk head, Outline E
- QAPSH-FF-1** - SMP(f) to SMA(f) bulk head, Outline F
- QAPSH-FF-2** - SMP(f) to SMA(f) bulk head, Outline G

Customization is available upon request.

Outline Drawings

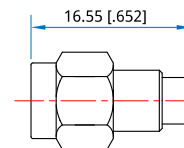

Outline A

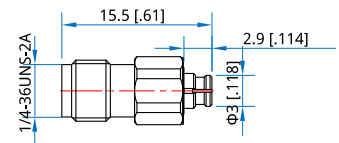

Outline B

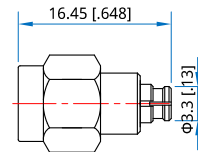

Outline C

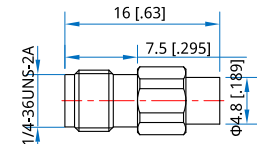

Outline D

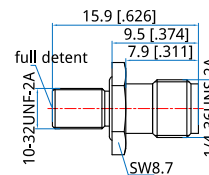

Outline E

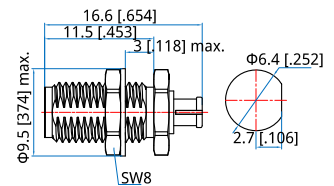

Outline F

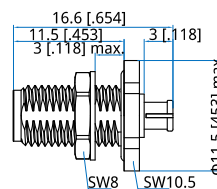

Outline G

Unit: mm [in]
Tolerance: ±0.2mm [±0.008in]

QAAS

SSMA to SMA

Features:
* Low VSWR

Applications:
* Wireless
* Transmitter
* Laboratory Test
* Radar

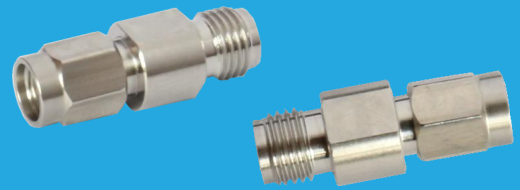

Electrical

Frequency: DC~26.5GHz
VSWR: 1.3 max.
Insertion Loss: 0.3dB max.
Impedance: 50Ω

Mechanical

RF Connectors: SSMA
SMA
Mating Life Cycle: 2000 cycles
Outer Conductor: Passivated SUS303 Stainless Steel
Dielectric: PEI
Inner Conductor: Gold Plated Beryllium Copper

Environmental

Temperature: -55~+85°C

Outline Drawings

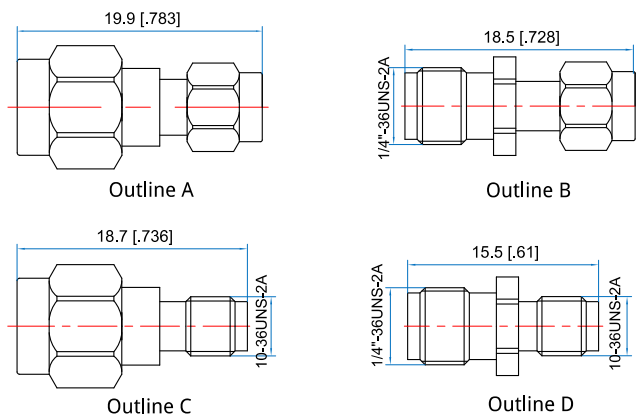

Unit: mm [in]

Tolerance: ±0.2mm [±0.008in]

How To Order

QAAS-MM - SSMA(m) to SMA(m), Outline A

QAAS-MF - SSMA(m) to SMA(f), Outline B

QAAS-FM - SSMA(f) to SMA(m), Outline C

QAAS-FF - SSMA(f) to SMA(f), Outline D

Customization is available upon request.

QASQS

SMA to Quick SMA

Features:
* Low VSWR

Applications:
* Wireless
* Transmitter
* Laboratory Test
* Radar

Electrical

Frequency: DC~26.5GHz
VSWR: 1.3 max.
Impedance: 50Ω

Mechanical

RF Connectors: SMA
Quick SMA
Outer Conductor: Gold plated brass or passivated stainless steel
Dielectric: PTFE
Inner Conductor: Gold plated beryllium copper or Gold plated brass

Outline Drawings

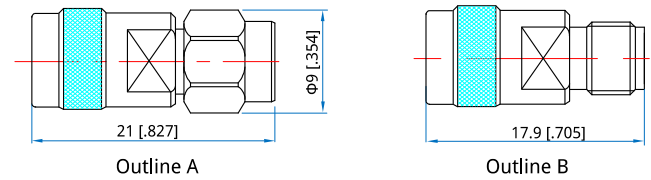

Unit: mm [in]
Tolerance: ±0.2mm [±0.008in]

How To Order

QASQS-MM - SMA (m) to Quick SMA (m), Outline A
QASQS-FM - SMA (f) to Quick SMA (m), Outline B

Customization is available upon request.

QA2N

2.4mm to N

Features:
* Low VSWR

Applications:
* Wireless
* Transmitter
* Laboratory Test
* Radar

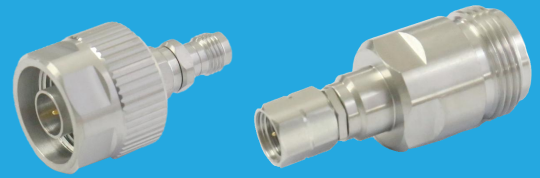

Electrical

Frequency: DC~18GHz
VSWR: 1.15 max.
Impedance: 50Ω

Mechanical

RF Connectors: 2.4mm
N
Mating Life Cycle: 2000 cycles
Outer Conductor: Passivated SUS303 Stainless Steel
Dielectric: PEI
Inner Conductor: Gold Plated Beryllium Copper

Environmental

Temperature: -60~+165°C

Outline Drawings

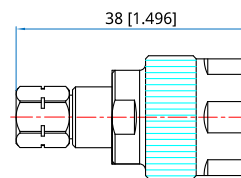

Outline A

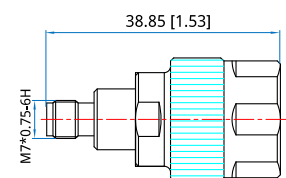

Outline B

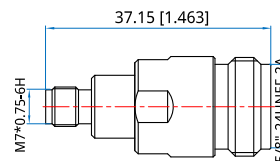

Outline C

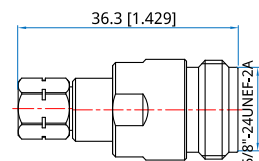

Outline D

Unit: mm [in]

Tolerance: ±0.2mm [±0.008in]

How To Order

QA2N-MM - 2.4mm (m) to N (m), Outline A

QA2N-FM - 2.4mm (f) to N (m), Outline B

QA2N-FF - 2.4mm (f) to N (f), Outline C

QA2N-MF - 2.4mm (m) to N (f), Outline D

Customization is available upon request.

QAKN 2.92mm to N

Features:
* Low VSWR

Applications:
* Wireless
* Transmitter
* Laboratory Test
* Radar

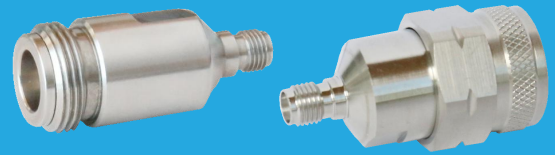

Electrical

Frequency:	DC~18GHz
VSWR:	1.15 max.
Insertion Loss:	0.3dB
Impedance:	50Ω

Mechanical

RF Connectors:	2.92mm N
Mating Life Cycle:	2000 cycles
Outer Conductor:	Passivated SUS303 Stainless Steel
Dielectric:	PEI
Inner Conductor:	Gold Plated Beryllium Copper

Environmental

Temperature:	-55~+125°C
--------------	------------

Outline Drawings

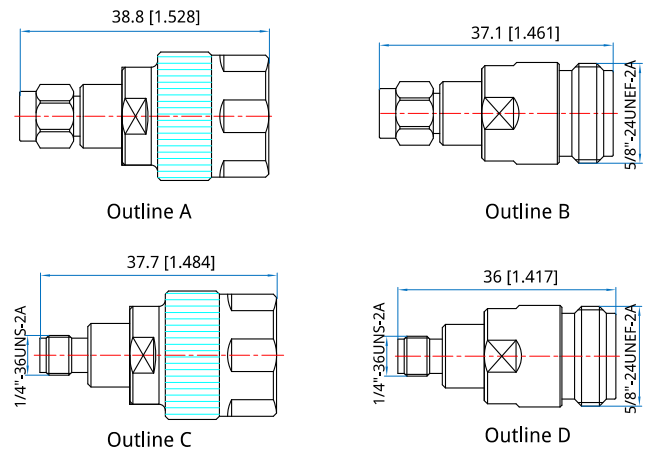

Unit: mm [in]
Tolerance: ±0.2mm [±0.008in]

How To Order

- QAKN-MM** - 2.92mm(m) to N(m), Outline A
- QAKN-MF** - 2.92mm(m) to N(f), Outline B
- QAKN-FM** - 2.92mm(f) to N(m), Outline C
- QAKN-FF** - 2.92mm(f) to N(f), Outline D

Customization is available upon request.

QA3N

3.5mm to N

Features:
* Low VSWR

Applications:
* Wireless
* Transmitter
* Laboratory Test
* Radar

Electrical

Frequency: DC~18GHz
VSWR: 1.2 max.
Impedance: 50Ω

Mechanical

RF Connectors: 3.5mm
N
Outer Conductor: Passivated stainless steel
Dielectric: PEI
Inner Conductor: Gold plated beryllium copper

Environmental

Temperature: -55~+165°C

Outline Drawings

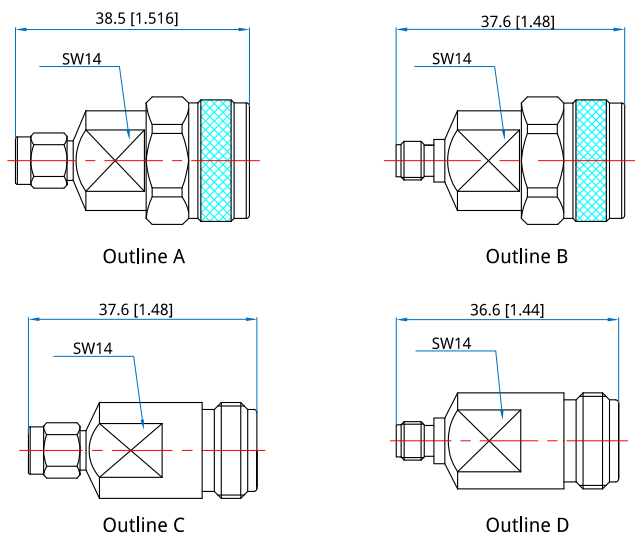

Unit: mm [in]

Tolerance: $\pm 0.2\text{mm}$ [$\pm 0.008\text{in}$]

How To Order

QA3N-MM - 3.5mm (m) to N (m), Outline A

QA3N-FM - 3.5mm (f) to N (m), Outline B

QA3N-MF - 3.5mm (m) to N (f), Outline C

QA3N-FF - 3.5mm (f) to N (f), Outline D

Customization is available upon request.

QASN SMA to N

Features:
* Low VSWR

Applications:
* Wireless
* Transmitter
* Laboratory Test
* Radar

Electrical

Frequency: DC~18GHz
VSWR: 1.15 max.
Impedance: 50Ω

Mechanical

RF Connectors: SMA
N
Mating Life Cycle: 500 cycles
Outer Conductor: Passivated stainless steel
Dielectric: PEI&PTFE
Inner Conductor: Gold plated brass or Gold plated beryllium copper

Environmental

Temperature: -50~+85°C

How To Order

QASN-MM - SMA (m) to N (m), Outline A

QASN-MF - SMA (m) to N (f), Outline B

QASN-FM - SMA (f) to N (m), Outline C

QASN-FF - SMA (f) to N (f), Outline D

QASNL-FF - SMA (f) to N (f) flange mount, Outline E

QASNH-FF-1 - SMA (f) to N (f) bulk head, Outline F

QASNH-FF-2 - SMA (f) to N (f) bulk head, Outline G

Customization is available upon request.

Outline Drawings

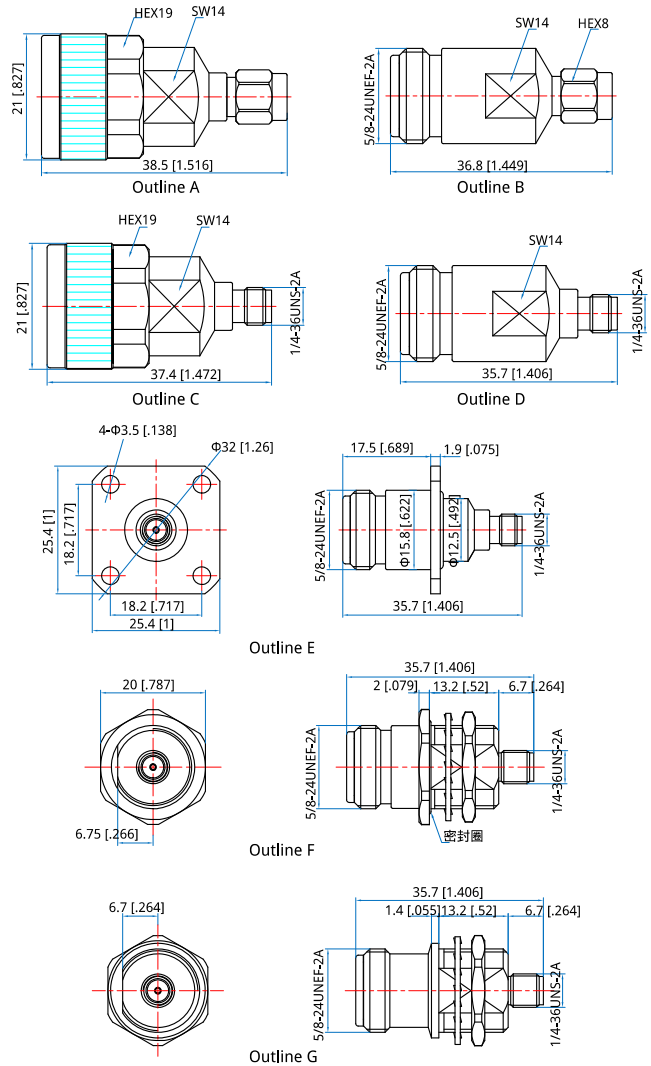

Unit: mm [in] Tolerance: ±0.2mm [±0.008in]

QASN-B SMA to N

Features:
* Low VSWR

Applications:
* Wireless
* Transmitter
* Laboratory Test
* Radar

Electrical

Frequency: DC~18GHz
VSWR: 1.2 max.
Impedance: 50Ω

Mechanical

RF Connectors: SMA
N
Mating Life Cycle: 500 cycles
Outer Conductor: Nickel plated brass
Dielectric: PEI&PTFE
Inner Conductor: Gold plated brass or gold plated phosphor bronze

Environmental

Temperature: -50~+85°C

How To Order

- QASN-MM-B** - SMA (m) to N (m), Outline A
- QASN-MF-B** - SMA (m) to N (f), Outline B
- QASN-FM-B** - SMA (f) to N (m), Outline C
- QASN-FF-B** - SMA (f) to N (f), Outline D
- QASNL-FF-B** - SMA (f) to N (f) flange mount, Outline E

Customization is available upon request.

Outline Drawings

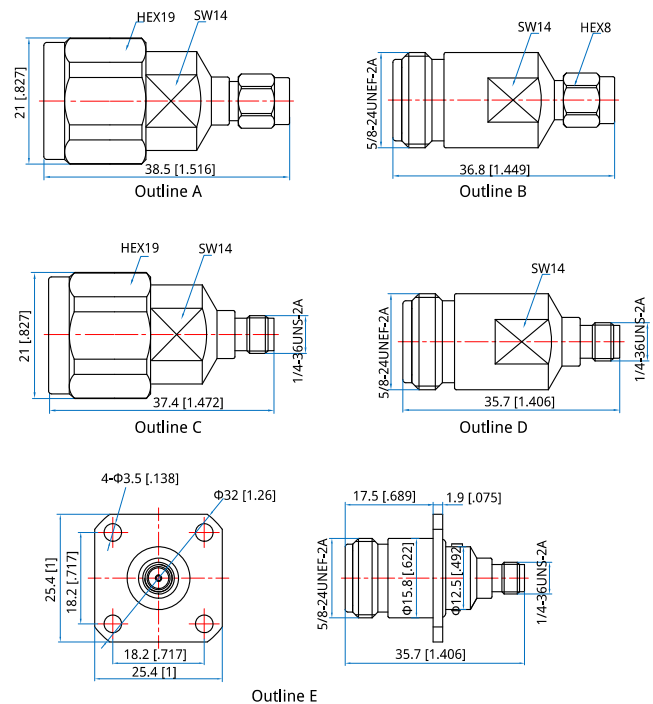

Unit: mm [in] Tolerance: ±0.2mm [±0.008in]

QAST SMA to TNC

Features:
* Low VSWR

Applications:
* Wireless
* Transmitter
* Laboratory Test
* Radar

Electrical

Frequency: 0.01~18GHz
VSWR: 1.2max.
VSWR (bulk head): 1.25max.
Impedance: 50Ω

Mechanical

RF Connectors: SMA
TNC
Outer Conductor: Passivated stainless steel
Passivated SUS303 stainless steel.(bulk head)
Dielectric: PEI&PTFE
PTFE(QAST-MF/QAST-FF)
Inner Conductor: Gold plated beryllium copper

Environmental

Temperature: -50~+85°C

How To Order

- QAST-MM** - SMA (m) to TNC (m), Outline A
- QAST-MF** - SMA (m) to TNC (f), Outline B
- QAST-FM** - SMA (f) to TNC (m), Outline C
- QAST-FF** - SMA (f) to TNC (f), Outline D
- QASTL-FF** - SMA (f) to TNC (f), flange mount, Outline E

Customization is available upon request.

Outline Drawings

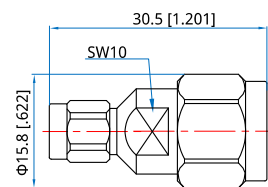

Outline A

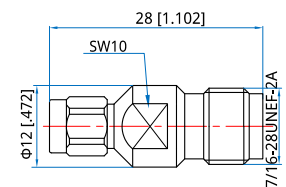

Outline B

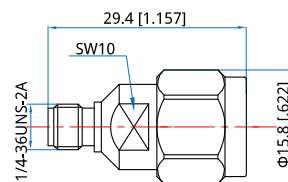

Outline C

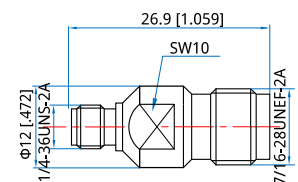

Outline D

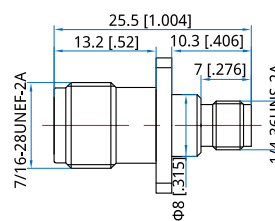

Outline E

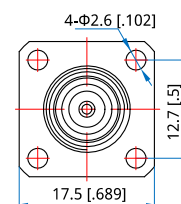

Unit: mm [in]
Tolerance: ±0.2mm [±0.008in]

QASI SMA to BMA

Features:
* Low VSWR

Applications:
* Wireless
* Transmitter
* Laboratory Test
* Radar

Electrical

Frequency: DC~18GHz
VSWR: 1.25 max.
1.15 max.(Outline A)
Impedance: 50Ω

Mechanical

RF Connectors: SMA
BMA
Outer Conductor: Passivated stainless steel
Dielectric: PTFE
Inner Conductor: Gold plated beryllium copper

Environmental

Temperature: -55~+85°C

How To Order

- QASI-FM** - SMA(f) to BMA(m), Outline A
- QASI-FF** - SMA(f) to BMA(f), Outline B
- QASI-MF** - SMA(m) to BMA(f), Outline C
- QASI-MM** - SMA(m) to BMA(m), Outline D
- QASIL-FM** - SMA(f) to BMA(m), flange mount Outline E
- QASIL-FM-02** - SMA(f) to BMA(m), flange mount, two holes Outline F

Customization is available upon request.

Outline Drawings

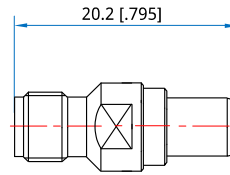

Outline A

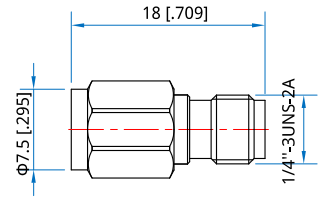

Outline B

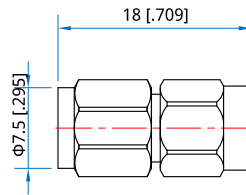

Outline C

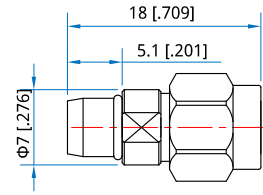

Outline D

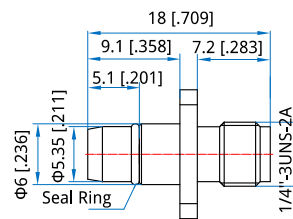

Outline E

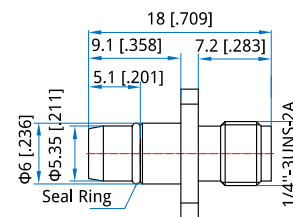
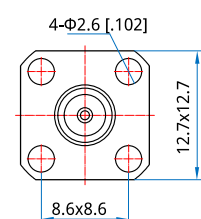

Outline F

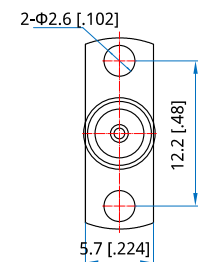

Unit: mm [in]
Tolerance: ±0.2mm [±0.008in]

QATN

TNC to N

Features:
* Low VSWR

Applications:
* Wireless
* Transmitter
* Laboratory Test
* Radar

Electrical

Frequency: 0.01~18GHz
VSWR: 1.2 max.
Impedance: 50Ω

Mechanical

RF Connectors: TNC
N
Outer Conductor: Stainless steel
Dielectric: PEI
PEI&PTFE(QATN-FM/QATN-FF)
Inner Conductor: Gold plated beryllium copper

Environmental

Temperature: -55~+165°C

Outline Drawings

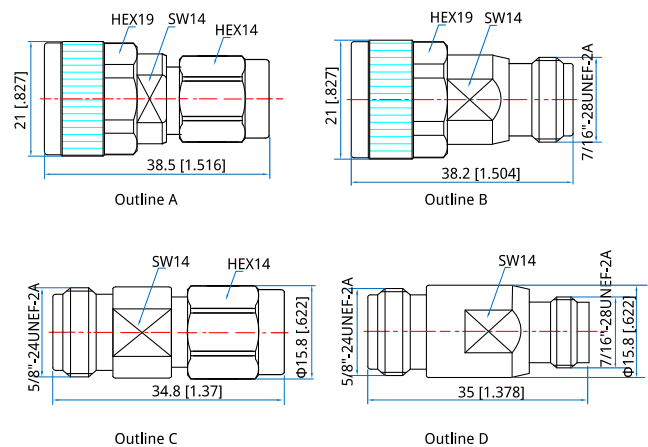

Unit: mm [in]

Tolerance: ±0.2mm [±0.008in]

How To Order

QATN-MM - TNC(m) to N(m), Outline A

QATN-FM - TNC(m) to N(f), Outline B

QATN-MF - TNC(f) to N(m), Outline C

QATN-FF - TNC(f) to N(f), Outline D

Customization is available upon request.

QANE

N to SC

Features:
* Low VSWR

Applications:
* Wireless
* Transmitter
* Laboratory Test
* Radar

Electrical

Frequency: DC~8GHz
VSWR: 1.15 max.
Impedance: 50Ω

Mechanical

RF Connectors: N
SC
Mating Life Cycle: 2000 cycles
Outer Conductor: Passivated SUS303 stainless steel
Dielectric: PTFE
Inner Conductor: Gold plated beryllium copper

Environmental

Temperature: -55~+165°C

Outline Drawings

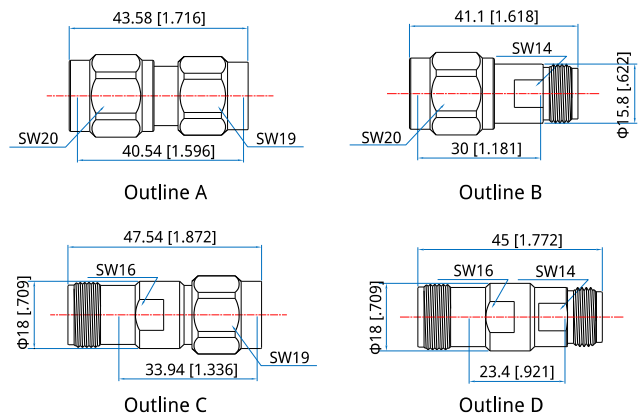

Unit: mm [in]

Tolerance: ±0.2mm [±0.008in]

How To Order

QANE-MM - N (m) to SC (m), Outline A

QANE-FM - N (f) to SC (m), Outline B

QANE-MF - N (m) to SC (f), Outline C

QANE-FF - N (f) to SC (f), Outline D

Customization is available upon request.

QAE7

SC to 7/16(DIN)

Features:
* Low VSWR

Applications:
* Wireless
* Transmitter
* Laboratory Test
* Radar

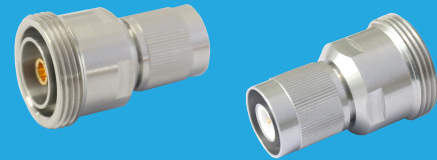

Electrical

Frequency: DC-6GHz
VSWR: 1.25 max.
Impedance: 50Ω

Mechanical

Length: 45.3mm
1.783in
RF Connectors: SC
7/16 DIN
Mating Life Cycle: 500 cycles
Outer Conductor: Nickel Plated Brass or SUS303
Stainless Steel
Dielectric: PTFE
Inner Conductor: Gold Plated Tin-phosphor
Bronze

Environmental

Temperature: -55~+85°C

Outline Drawings

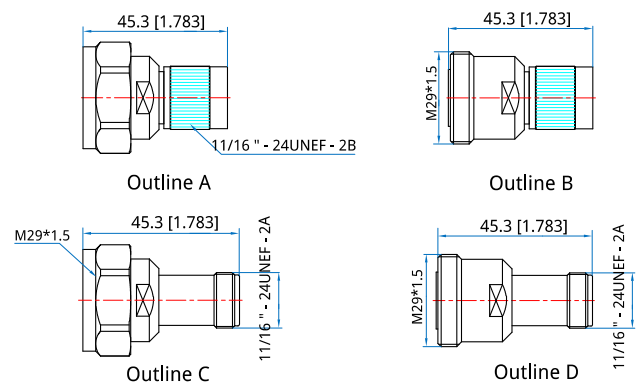

Unit: mm [in]
Tolerance: $\pm 0.2\text{mm}$ [$\pm 0.008\text{in}$]

How To Order

QAE7-MM - SC(m) to 7/16 DIN(m), Outline A

QAE7-MF - SC(m) to 7/16 DIN(f), Outline B

QAE7-FM - SC(f) to 7/16 DIN(m), Outline C

QAE7-FF - SC(f) to 7/16 DIN(f), Outline D

Customization is available upon request.

QAN7

N to 7/16(DIN)

Features:
* Low VSWR

Applications:
* Wireless
* Transmitter
* Laboratory Test
* Radar

Electrical

Frequency: DC~7.5GHz
VSWR: 1.1 max. @3GHz
Impedance: 50Ω

Mechanical

RF Connectors: N
7/16(DIN)
Outer Conductor: Ternary alloy plated brass
Dielectric: PTFE
Inner Conductor: Silver plated tin phosphorus
bronze or silver plated brass

Environmental

Temperature: -40~+85°C

Outline Drawings



图1



图2

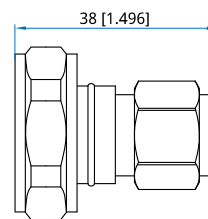

图3

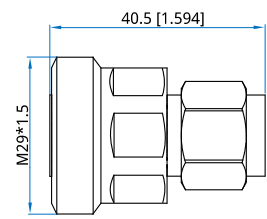

图4

Unit: mm [in]
Tolerance: ±0.2mm [±0.008in]

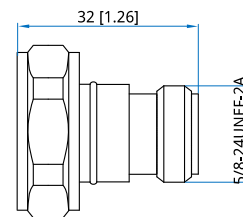
How To Order

QAN7-MM - N (m) to 7/16(DIN) (m), Outline A

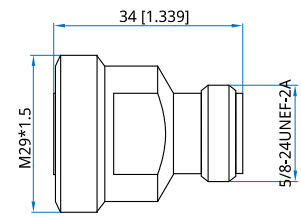
QAN7-MF - N (m) to 7/16(DIN) (f), Outline B

QAN7-FM - N (f) to 7/16(DIN) (m), Outline C

QAN7-FF - N (f) to 7/16(DIN) (f), Outline D

Customization is available upon request.

QANB-B N to BNC

Features:
* Low VSWR

Applications:
* Wireless
* Transmitter
* Laboratory Test
* Radar

Electrical

Frequency: DC~6GHz
VSWR: 1.35 max.
Impedance: 50Ω

Mechanical

RF Connectors: N
BNC
Outer Conductor: Nickel plated brass
Dielectric: PTFE
Inner Conductor: Gold plated brass or gold plated phosphor copper

Environmental

Operating Temperature: -55~+155°C

Outline Drawings

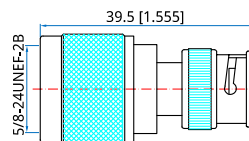

Outline A

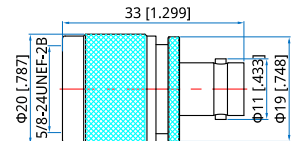

Outline B

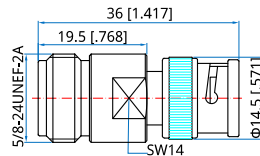

Outline C

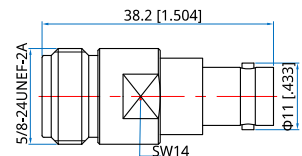

Outline D

Unit: mm [in]

Tolerance: ±0.2mm [±0.008in]

How To Order

QANB-MM-B - N (m) to BNC (m), Outline A

QANB-MF-B - N (m) to BNC (f), Outline B

QANB-FM-B - N (f) to BNC (m), Outline C

QANB-FF-B - N (f) to BNC (f), Outline D

Customization is available upon request.

QASB-B

SMA to BNC

Features:
* Low VSWR

Applications:
* Wireless
* Transmitter
* Laboratory Test
* Radar

Electrical

Frequency:	DC~6GHz DC~3GHz (bulk head)
VSWR:	1.35 max. 1.25 max. (bulk head)
Impedance:	50Ω

Mechanical

RF Connectors:	SMA BNC
Outer Conductor:	Nickel plated brass
Dielectric:	PTFE
Inner Conductor:	Gold plated brass or gold plated phosphor copper

Environmental

Operating Temperature: -55~+155°C

How To Order

QASB-MM-B - SMA(m) to BNC(m), Outline A

QASB-FM-B - SMA(f) to BNC(m), Outline B

QASB-MF-B - SMA(m) to BNC(f), Outline C

QASB-FF-B - SMA(f) to BNC(f), Outline D

QASBH-FF-B - SMA(f) to BNC(f), bulk head, Outline E

Customization is available upon request.

Outline Drawings

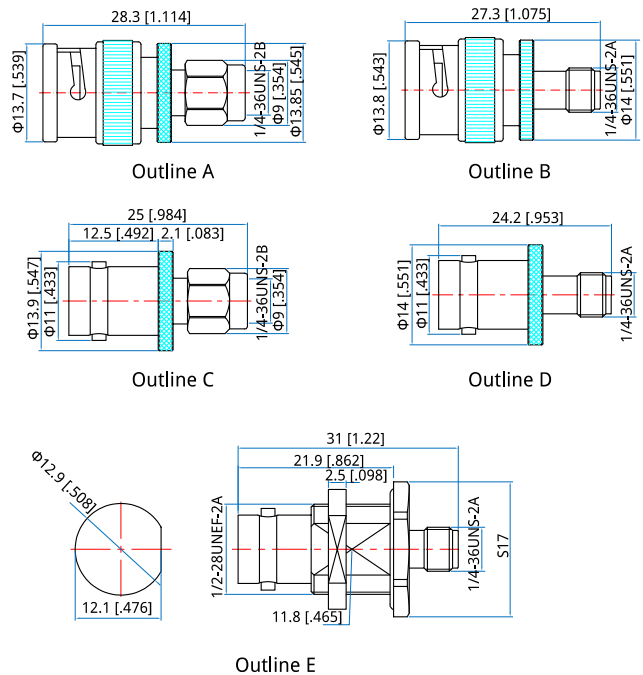

Unit: mm [in]

Tolerance: ±0.2mm [±0.008in]

QASQ-B

SMA to QMA, DC~6GHz

Features:
* Low VSWR

Applications:
* Wireless
* Transmitter
* Laboratory Test
* Radar

Electrical

Frequency: DC~6GHz
VSWR: 1.25 max.
Impedance: 50Ω

Mechanical

RF Connectors: SMA
QMA
Outer Conductor: Gold plated brass
Dielectric: PTFE
Inner Conductor: Gold plated phosphor bronze

Outline Drawings

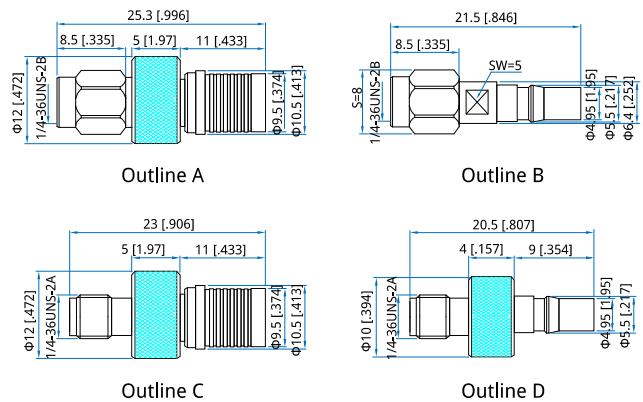

Unit: mm [in]

Tolerance: ±0.2mm [±0.008in]

How To Order

QASQ-MM-B - SMA (m) to QMA (m), Outline A

QASQ-MF-B - SMA (m) to QMA (f), Outline B

QASQ-FM-B - SMA (f) to QMA (m), Outline C

QASQ-FF-B - SMA (f) to QMA (f), Outline D

Customization is available upon request.